

ADX AluPanel System

Product Identification

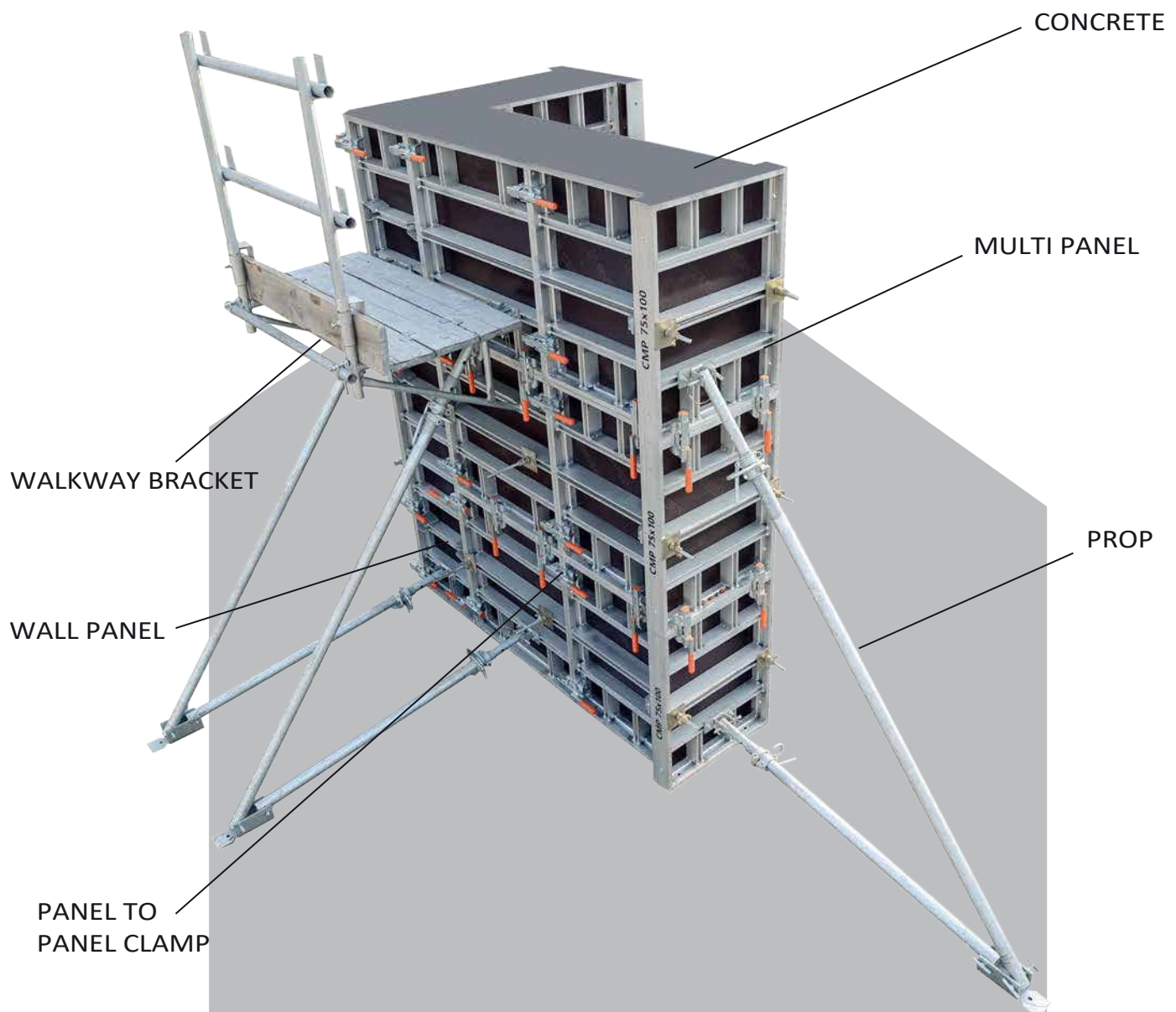

ADX AluPanel System

Product Identification

WALL PANELS

Wall panels are the fastest way securing structure for concrete wall.

MATERIAL

Aluminium Alloy 6061-T6 / Equivalent

FINISH

Mill Finish

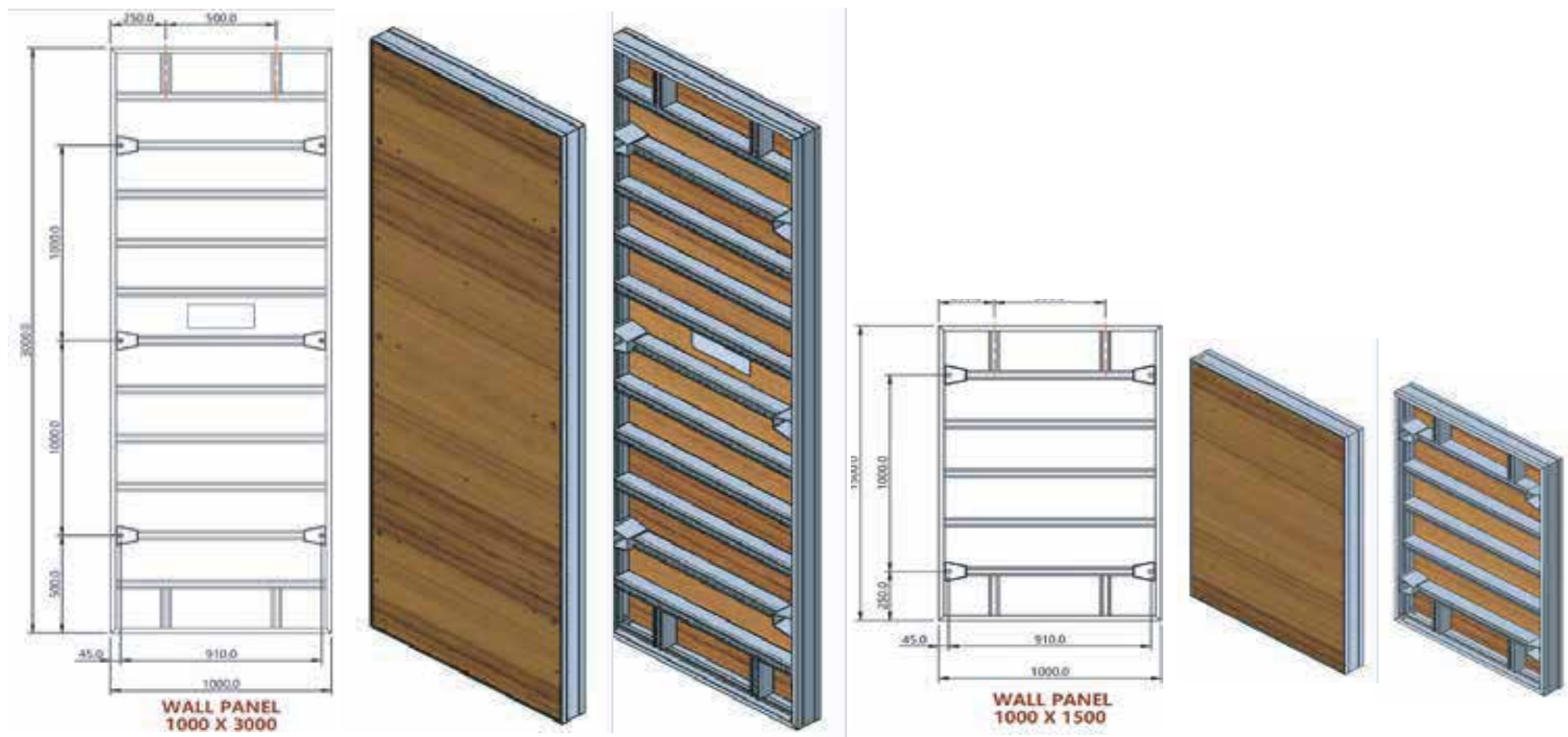

Item Code	Description	Width & Height MM	Weight Kg
ADXW100300	ADX Aluminium Wall Panel with Plywood	1000 x 3000	83.40
ADXW100150	ADX Aluminium Wall Panel with Plywood	1000 x 1500	46.70
ADXW100100	ADX Aluminium Wall Panel with Plywood	1000 x 1000	31.90
ADXW100075	ADX Aluminium Wall Panel with Plywood	1000 x 750	27.20
ADXW100050	ADX Aluminium Wall Panel with Plywood	1000 x 500	19.80
ADXW075300	ADX Aluminium Wall Panel with Plywood	750 x 3000	62.10
ADXW075150	ADX Aluminium Wall Panel with Plywood	750 x 1500	34.50
ADXW075100	ADX Aluminium Wall Panel with Plywood	750 x 1000	23.40
ADXW075075	ADX Aluminium Wall Panel with Plywood	750 x 750	20.60
ADXW075050	ADX Aluminium Wall Panel with Plywood	750 x 500	14.60

ADX AluPanel System

Product Identification

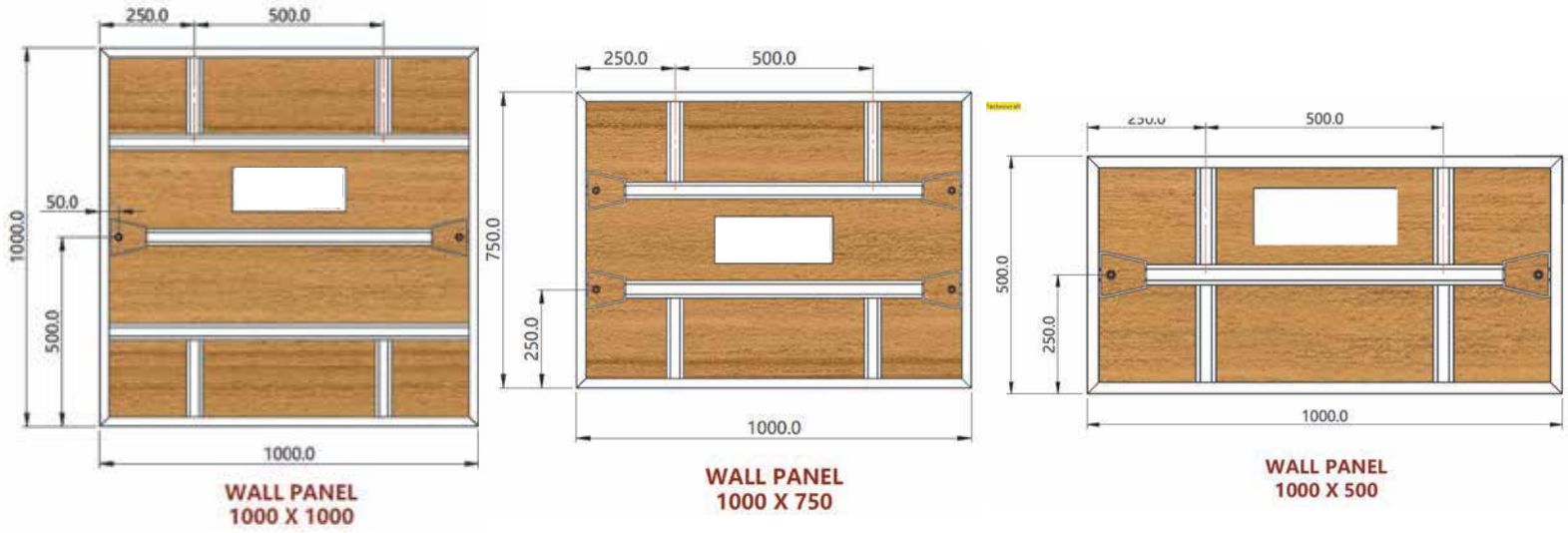

Item Code	Description	Width & Height MM	Weight Kg
ADWX100100	ADX Aluminium Wall Panel with Plywood	1000 x 1000	30.60
ADWX075100	ADX Aluminium Wall Panel with Plywood	750 x 1000	22.90
ADWX060100	ADX Aluminium Wall Panel with Plywood	600 x 1000	19.30
ADWX050100	ADX Aluminium Wall Panel with Plywood	500 x 1000	17.30
ADWX045100	ADX Aluminium Wall Panel with Plywood	450 x 1000	16.40
ADWX030100	ADX Aluminium Wall Panel with Plywood	300 x 1000	12.70
ADWX015100	ADX Aluminium Wall Panel with Plywood	150 x 1000	10.00

Item Code	Description	Width & Height MM	Weight Kg
ADWX100075	ADX Aluminium Wall Panel with Plywood	1000 x 750	25.40
ADWX075075	ADX Aluminium Wall Panel with Plywood	750 x 750	19.10
ADWX060075	ADX Aluminium Wall Panel with Plywood	600 x 750	16.10
ADWX050075	ADX Aluminium Wall Panel with Plywood	500 x 750	14.50
ADWX045075	ADX Aluminium Wall Panel with Plywood	450 x 750	13.80
ADWX030075	ADX Aluminium Wall Panel with Plywood	300 x 750	10.70
ADWX015075	ADX Aluminium Wall Panel with Plywood	150 x 750	8.00

Item Code	Description	Width & Height MM	Weight Kg
ADWX100050	ADX Aluminium Wall Panel with Plywood	1000 x 500	18.50
ADWX075050	ADX Aluminium Wall Panel with Plywood	750 x 500	13.70
ADWX060050	ADX Aluminium Wall Panel with Plywood	600 x 500	11.40
ADWX050050	ADX Aluminium Wall Panel with Plywood	500 x 500	10.20
ADWX045050	ADX Aluminium Wall Panel with Plywood	450 x 500	9.60
ADWX030050	ADX Aluminium Wall Panel with Plywood	300 x 500	7.20
ADWX015050	ADX Aluminium Wall Panel with Plywood	150 x 500	5.80

ADX AluPanel System

Product Identification

MULTIPANELS

Multi panels are also known as Column panel, it can be used for walls & column.

Material: Aluminium Alloy 6061-T6 / Equivalent **Finish:** Mill Finish

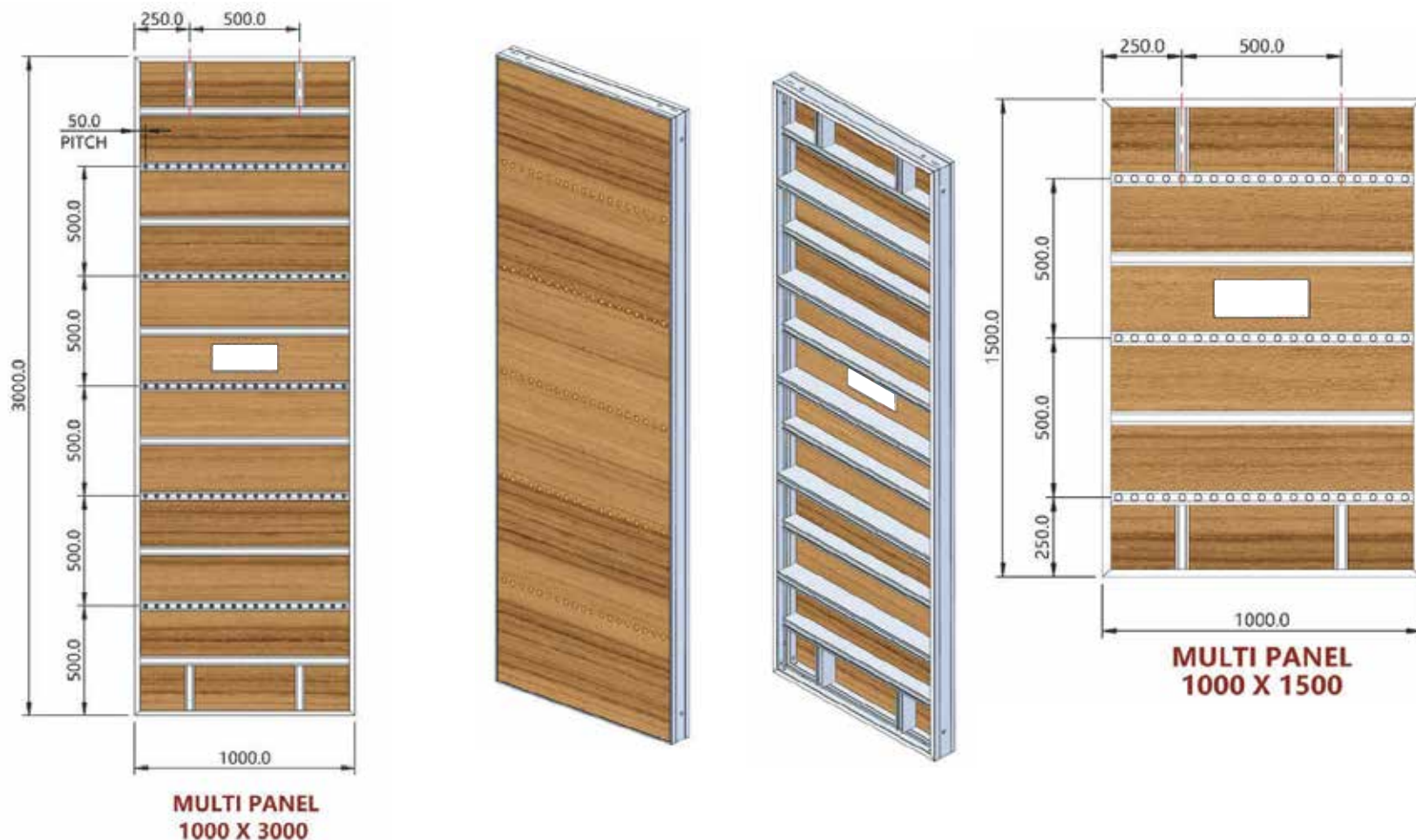

Item Code	Description	Width & Height MM	Weight Kg
ADXW100300	ADX Aluminium Multi Panel with Plywood	1000 x 3000	83.40
ADXW100150	ADX Aluminium Multi Panel with Plywood	1000 x 1500	46.70
ADXW100100	ADX Aluminium Multi Panel with Plywood	1000 x 1000	31.90
ADXW100075	ADX Aluminium Multi Panel with Plywood	1000 x 750	27.20
ADXW100050	ADX Aluminium Multi Panel with Plywood	1000 x 500	19.80
ADXW075300	ADX Aluminium Multi Panel with Plywood	750 x 3000	62.10
ADXW075150	ADX Aluminium Multi Panel with Plywood	750 x 1500	34.50
ADXW075100	ADX Aluminium Multi Panel with Plywood	750 x 1000	23.40
ADXW075075	ADX Aluminium Multi Panel with Plywood	750 x 750	20.60
ADXW075050	ADX Aluminium Multi Panel with Plywood	750 x 500	14.60

ADX AluPanel System

Product Identification

INTERNAL CORNER PANELS

Internal corner panels used to make internal joints between two walls or multi panels firmly with smooth continuous finish.

Material: Aluminium Alloy 6061-T6 / Equivalent

Finish: Mill Finish

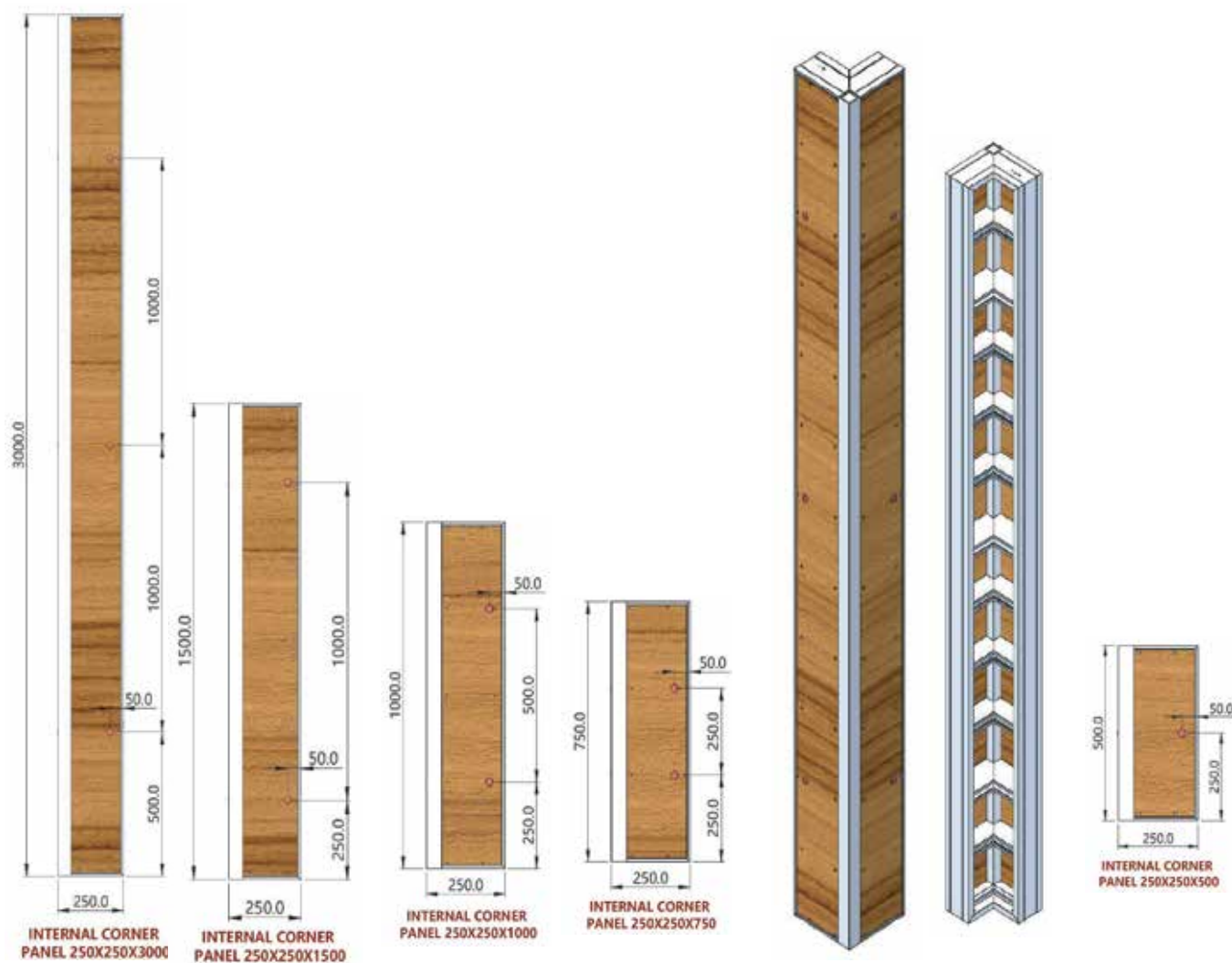

Item Code	Description	Width & Height MM	Weight Kg
ADXIC025300	ADX Internal Corner Panel with plywood	250 x 250 x 3000	43.10
ADXIC025150	ADX Internal Corner Panel with plywood	250 x 250 x 1500	22.90
ADXIC025100	ADX Internal Corner Panel with plywood	250 x 250 x 1000	17.00
ADXIC025075	ADX Internal Corner Panel with plywood	250 x 250 x 750	12.90
ADXIC025050	ADX Internal Corner Panel with plywood	250 x 250 x 500	9.70

ADX AluPanel System

Product Identification

OUTSIDE CORNER PANELS

Outside corner panels used to make outer joints between two wall or multi panels firmly with smooth continuous finish.

MATERIAL

Aluminium Alloy 6061-T6 / Equivalent

FINISH

Mill Finish

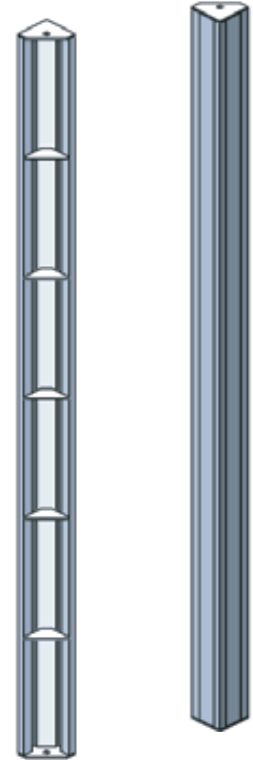

Item Code	Description	Width & Height MM	Weight Kg
ADXOC012300	ADX Outside Corner Panel	120 x 120 x 3000	19.10
ADXOC012150	ADX Outside Corner Panel	120 x 120 x 1500	9.70
ADXOC012100	ADX Outside Corner Panel	120 x 120 x 1000	6.80
ADXOC012075	ADX Outside Corner Panel	120 x 120 x 750	5.00
ADXOC012050	ADX Outside Corner Panel	120 x 120 x 500	3.40

SWING CORNER PANELS

Swing corner is used when there is requirement of concrete wall casting other than 90° (Perpendicular).

MATERIAL

Aluminium Alloy 6061-T6 / Equivalent

FINISH

Mill Finish

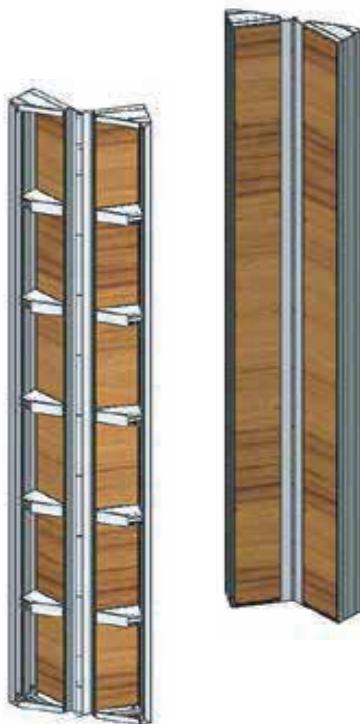

Item Code	Description	Width & Height MM	Weight Kg
ADXSC025300	ADX Swing Corner Panel with Plywood	250 x 250 x 3000	49.30
ADXSC025150	ADX Swing Corner Panel with Plywood	250 x 250 x 1500	25.00
ADXSC025100	ADX Swing Corner Panel with Plywood	250 x 250 x 1000	18.30

ADX AluPanel System

Product Identification

WALKWAY BRACKET

Board brackets are used to extend the work platform closer to the structure.

MATERIAL

Structural Steel

FINISH

HDG

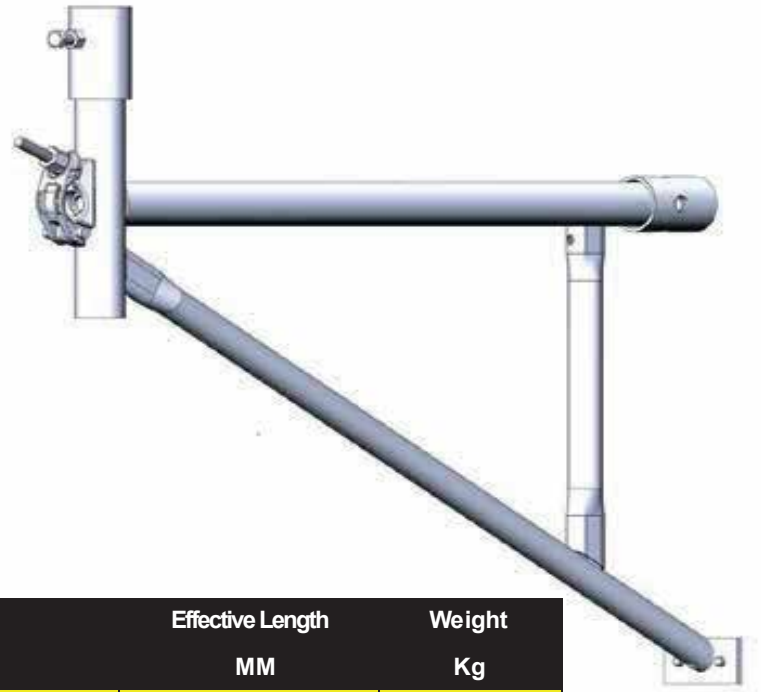

Item Code	Description	Effective Length MM	Weight Kg
ADXWB	ADX Walkway Bracket(225 x 3 Planks) with 1 Pin	800	8.40

HAND RAILING POST 1.0 M

Hand rails are used to provide safety measures to the workers working on platform. This handrails is attached to the brackets.

MATERIAL
Structural Steel

FINISH
HDG

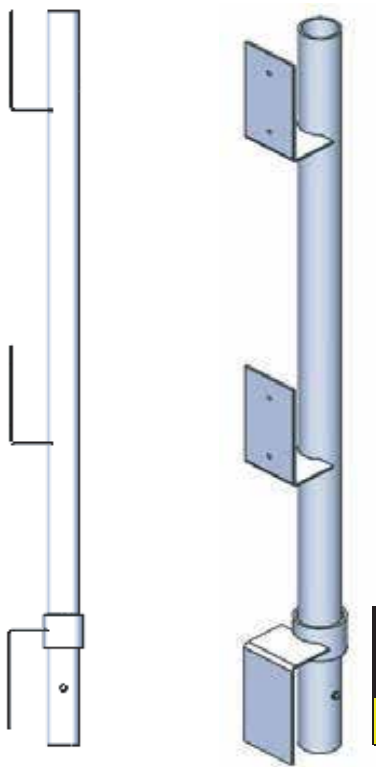

Item Code	Description	Effective Length MM	Weight Kg
ADXHRP	ADX Hand Railing Post 1.0	1000	5.70

ADX AluPanel System

Product Identification

BOTTOM BRACKET

Bottom brackets are used to hold and provide angular movement to the Raker Props at the bottom of the surface or slab.

MATERIAL

Structural Steel

FINISH

Electroplated

Item Code	Description	Weight Kg
ADX2BB	ADX Bottom Bracket with 2 Pins	4.80

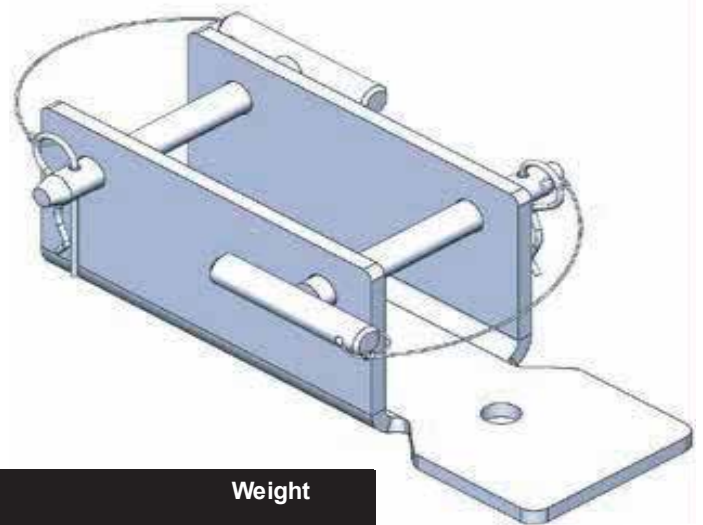

TOP BRACKET

Top brackets are used to hold and provide angular movement to the Raker Props. And it is also used to hold walkways bracket using connecting pin. To be used for 450mm wide and above panels.

MATERIAL

Structural Steel

FINISH

Electroplated

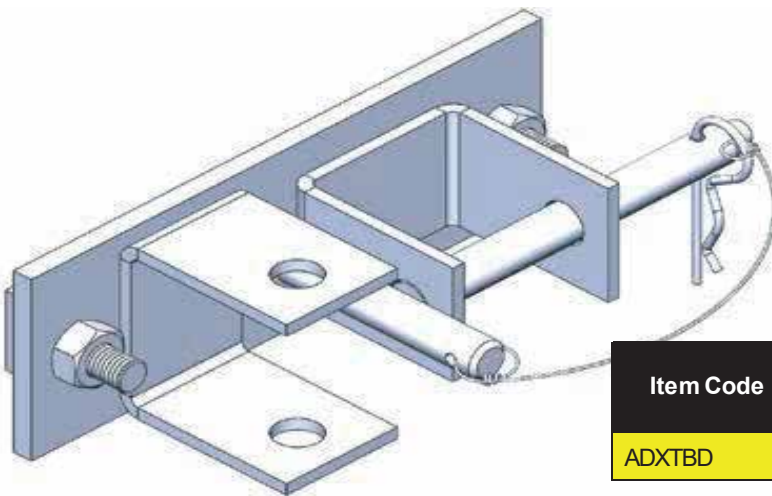

Item Code	Description	Weight Kg
ADXTBD	ADX Top Bracket with Double U (1 Pin)	2.60

TOP BRACKET WITH SINGLE U

Top brackets are used to hold and provide angular movement to the Raker Props or Walkway bracket. To be used for 300mm wide & below panels.

Material: Structural Steel

Finish: HDG

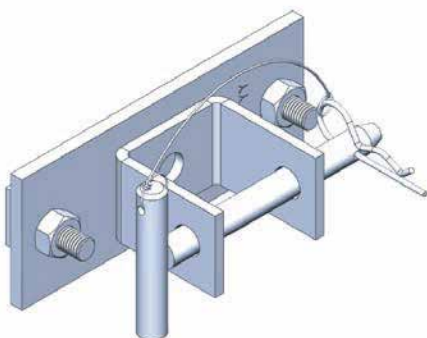

Item Code	Description	Weight Kg
ADXTBS	ADX Top Bracket with Single U (1 Pin)	2.00

ADX AluPanel System

Product Identification

FOOTING BRACKET

Footings bracket are crucial in the case of casting of the single side wall, it can be anchor to the base, keeping wall panels intact to the base/flooring.

MATERIAL:
Structural Steel

FINISH:
HDG

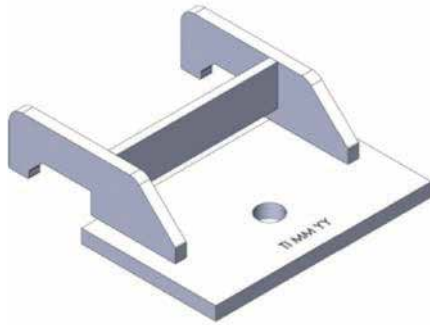

Item Code	Description	Weight Kg
ADXFB	ADX Footing Bracket	2.00

MULTI PANEL TIE CLAMP

This clamp is specially designed to use for clamping of wall panel with multi panel generally at the end of the wall.

MATERIAL
Structural Steel

FINISH
Electroplated

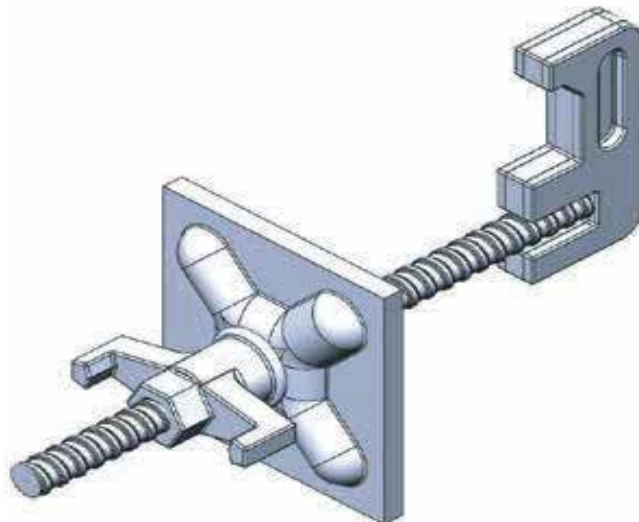

Item Code	Description	Weight Kg
ADXMPTC	ADX Multi Panel Tie Clamp	3.60

ADX AluPanel System

Product Identification

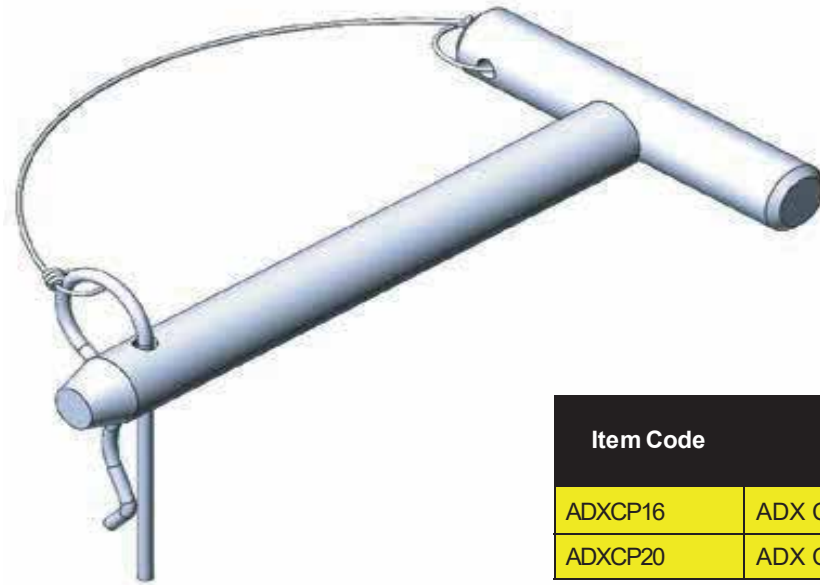

CONNECTING PIN

Connecting pins are used to connect props & brackets to the Wall panels.

MATERIAL

Structural Steel

FINISH

Electroplated

Item Code	Description	Weight Kg
ADXCP16	ADX Connecting Pin	0.40
ADXCP20	ADX Connecting Pin	0.50

RAKER PROP

Prop is use to rigidity to the ADX AluPanel System it is easily attached to the wall panels using Top & Bottom Brackets.

MATERIAL

Structural Steel

FINISH

HDG

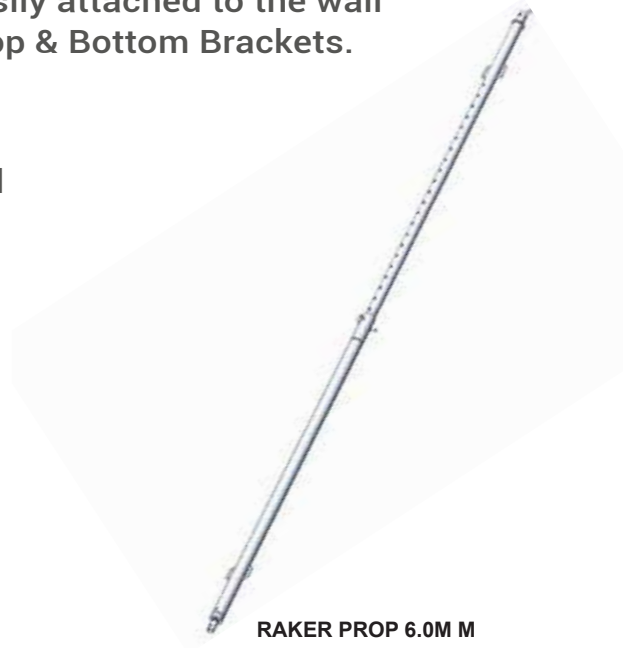

RAKER PROP 6.0M M

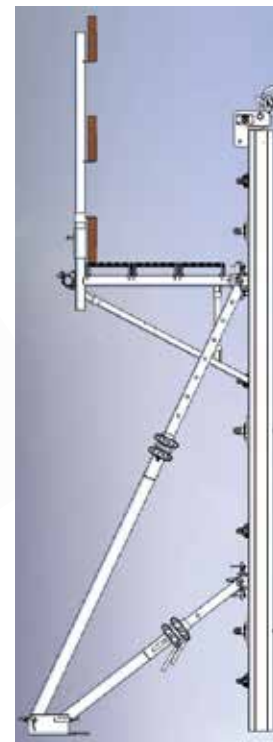

RAKER PROP 3.0M & 1.5M

Item Code	Description	Min. & Max. Extention MM	Weight Kg
ADXRP45	ADX Raker Prop	2600 - 4500	24.90
APXRP26	ADX Raker Prop	1500 - 2600	15.00

ADX AluPanel System

Product Identification

UNIVERSAL WALER

Universal waler is used to connect two panels firmly. This waler can be fixed horizontally or vertically using Tie Rod.

Material: Structural Steel

Finish: HDG

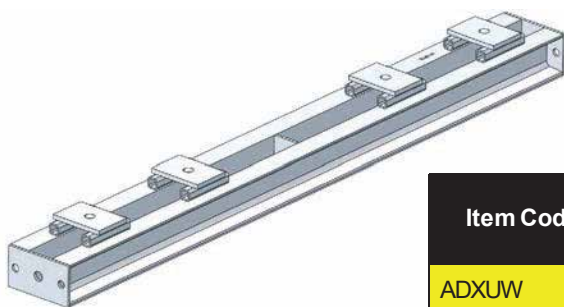

Item Code	Description	Weight Kg
ADXUW	ADX Universal Waler	21.40

UNIVERSAL WALER TIE CLAMP

Universal waler Tie clamp is used to clamp Panel and universal waler.

Material: Structural Steel

Finish: Electroplated

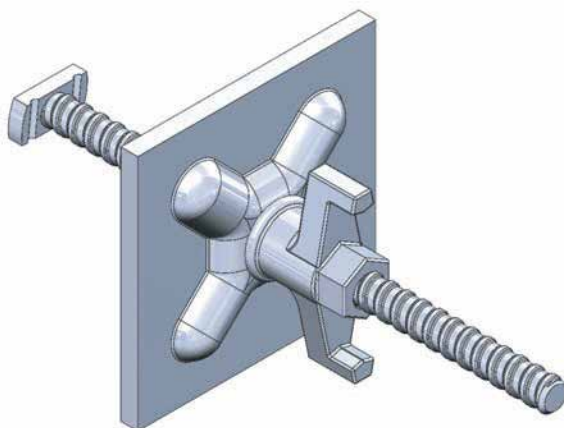

Item Code	Description	Weight Kg
ADXUWTC	ADX Universal Waler Tie Clamp	2.50

ADX AluPanel System

Product Identification

HINGE WALERS

Hinge waler is special purpose waler used to align panels at angular wall (concrete) structure.

MATERIAL
Structural Steel

FINISH
HDG

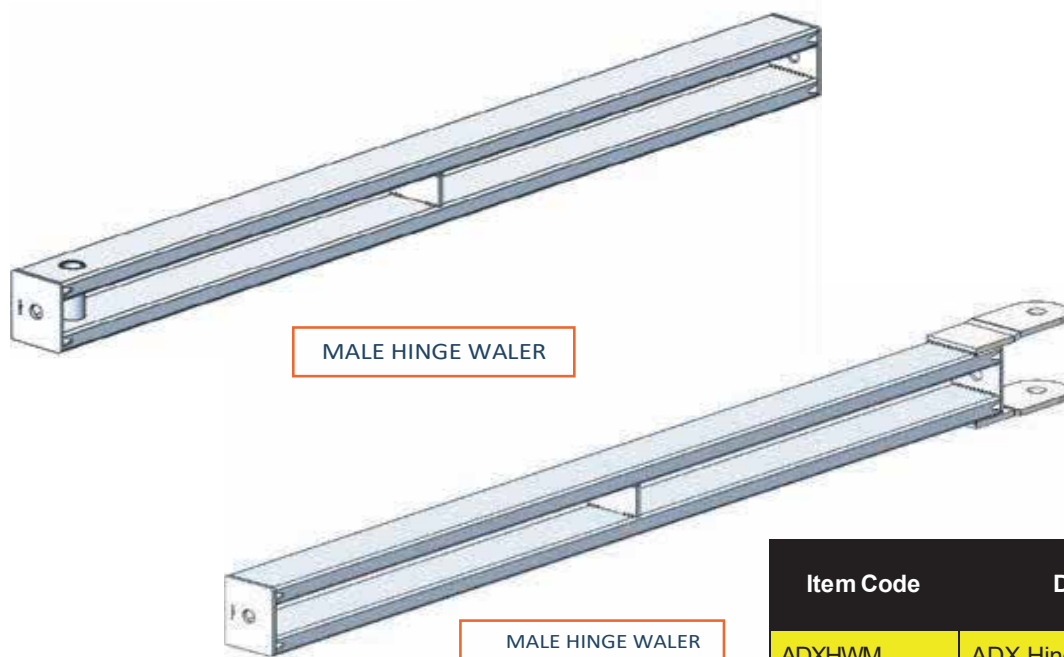

Item Code	Description	Weight Kg
ADXHWM	ADX Hinge Waler - Male	11.90
ADXHWF	ADX Hinge Waler - Female	13.30

350MM WIDE STEEL LADDER

Steel scaffold ladders are used in conjunction with ladder brackets so that workers can access the elevated work platforms safely.

MATERIAL
Structural Steel

FINISH
HDG

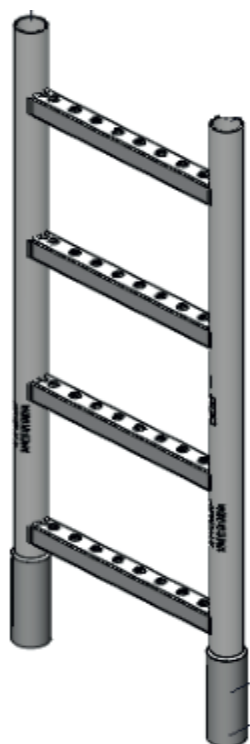

Item Code	Description	Height MM	Weight Kg
ADXLW3AS	350mm Width Steel Ladder	1000	6.60
ADXLW10AS	350mm Width Steel Ladder	3000	18.40

ADX AluPanel System

Product Identification

LADDER CONNECTOR

Ladder connector is used to connect ladder to the wall panels firmly.

MATERIAL

Structural Steel

FINISH

Electroplated

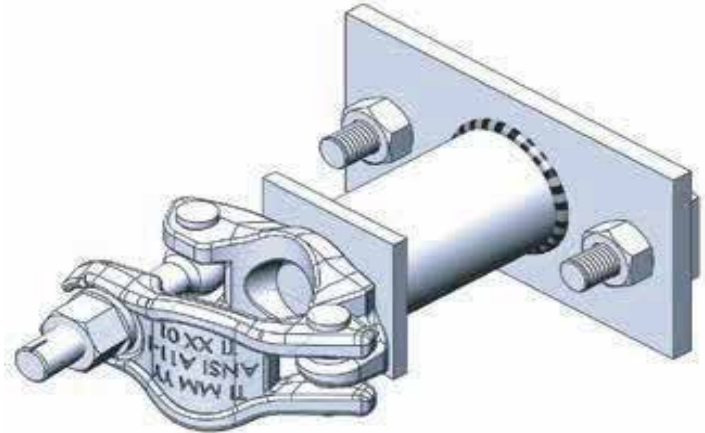

Item Code	Description	Weight Kg
ADXL	ADX Ladder Connector	2.10

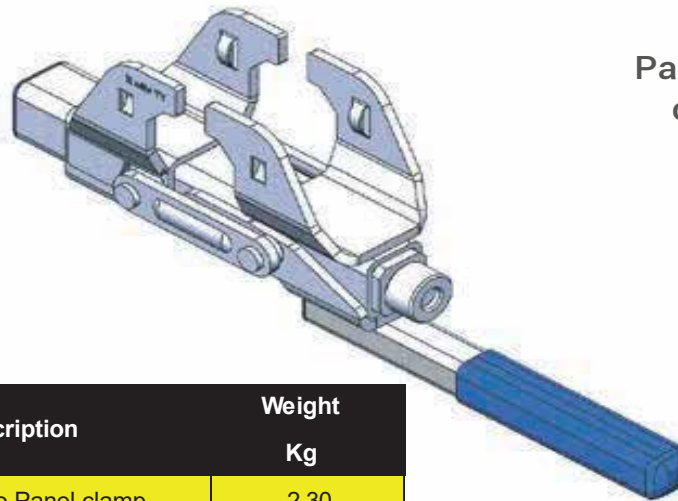

PANEL TO PANEL CLAMP

Panel to panel clamp is used to clamp two wall panels firmly.

MATERIAL

Structural Steel

FINISH

Electroplated

Item Code	Description	Weight Kg
ADXP	ADX Panel to Panel clamp	2.30

ADJUSTABLE PANEL CLAMP

Adjustable panel clamp is used to clamp wall panels when there is gap between the two panels which is filled (Adjusted) by timber.

MATERIAL

Structural Steel

FINISH

Electroplated



Item Code	Description	Max Opening Size MM	Weight Kg
ADXP30	ADX Adjustable Panel Clamp	300	4.50
ADXP15	ADX Adjustable Panel Clamp	150	4.00

ADX AluPanel System

Product Identification

BULK HEAD TIE CLAMP

Bulk head tie clamp is used to clamp plywood at the end of the wall panels sides by keeping waler between plywood and base plate of the tie clamp.

MATERIAL

Structural Steel

FINISH

Electroplated

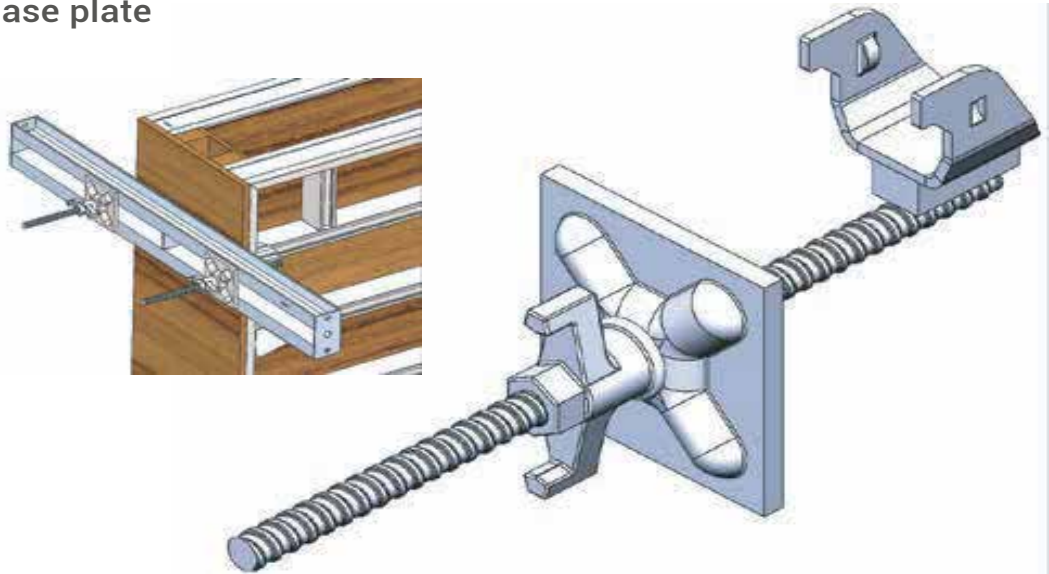

Item Code	Description	Weight Kg
ADXBHTC	ADX Bulk Head Tie Clamp	3.10

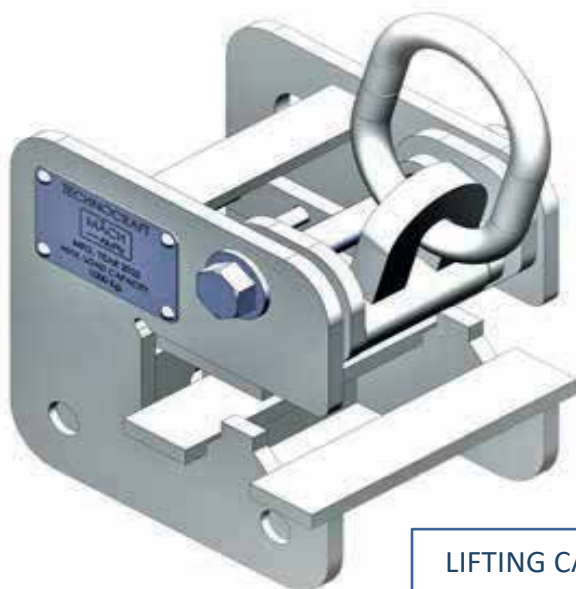

LIFTING CAPACITY = 15 kN

LIFTING BRACKET

Lifting Bracket is used to lift the pre-assembled Wall panels with accessories firmly.

MATERIAL

Structural Steel

FINISH

Electroplated

Item Code	Description	Weight Kg
ADXLB	ADX Lifting Bracket	8.30

ADX AluPanel System

Product Identification

SYSTEM CHARACTERISTICS

External side of wall panels are welded with End Rail Profile, ribs are welded at every 25cm. The plywood is screwed to the wall panels.

END OR SIDE RAIL PANEL PROFILE

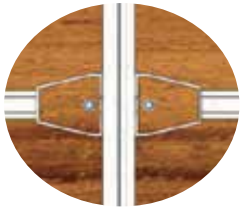

Two holes are allow Tie clamps to clamp panels with each other.

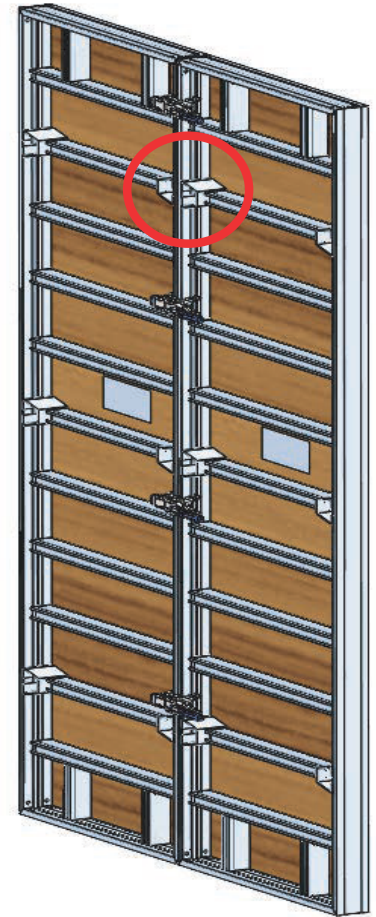

SYSTEM CHARACTERISTICS

Material	Aluminium Alloy 6061-T6
Sizes Range	Width- 300 to 1000 Height- 3000
Finish	Width- 300 to 1000 Height- 1500
Permissible Allowance Fresh	Mill
Concrete Pressure	60kN/msq.

PLYWOOD CHARACTERISTICS

12 mm Birch Plywood is lightweight, sturdy and economical to use in ADX AluPanel System. It provides smooth surface finish to the concrete after casting.

12 mm Birch Plywood

Thickness	12.0 mm
Coating- Filmfaced	220 GSM
Weight	8.2 kg/mq
Thermal Conductivity	0.175 W/m'K
Internal Composition	9 Layers (Birch)
External Protection	Phenolic Resin
Number of Re-uses	Min 50-60
Sides	Painted
Absorption of Humidity- Protected panel	Null
Absorption of Humidity- Cut panel	Elevated
Releases	Required
Repairs	With Feelers

ADX AluPanel System

Product Identification

ASSEMBLY OF AluPanel WALLS

PRE ASSEMBLY:

Keep Wall panels on Wooden support block align them & clamp using Panel To Panel clamp as shown.

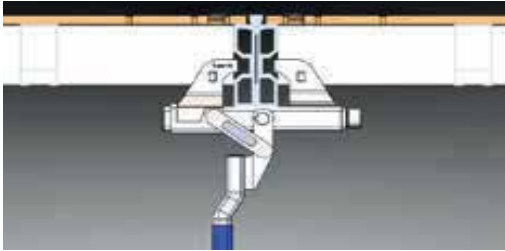

UNLOCK POSITION

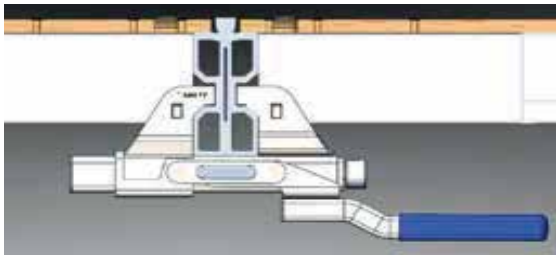

LOCK POSITION

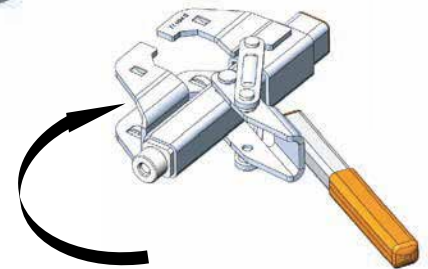
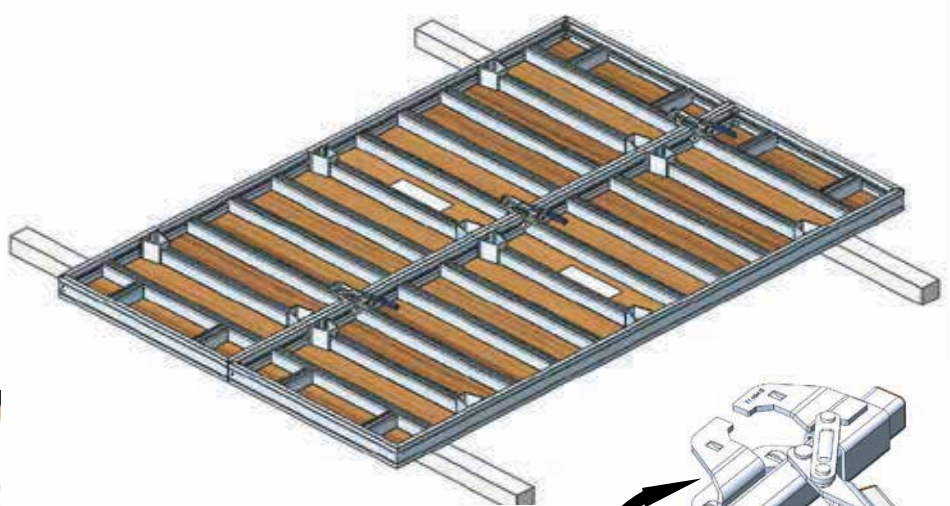

PRESSURE REGULATOR

- After clamping of panels with each other, assemble top bracket to the wall panels & attach walkway brackets using connecting pin.
- Props can be assemble to the top brackets as shown.
- After assembly of accessories to the wall panel carefully mount lifting clamp.

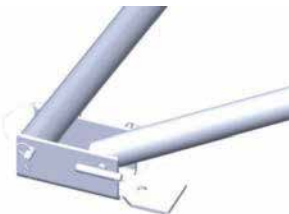

THE BOTTOM BRACKET IS ATTACHED TO THE PROPS USING CONNECTING PIN.

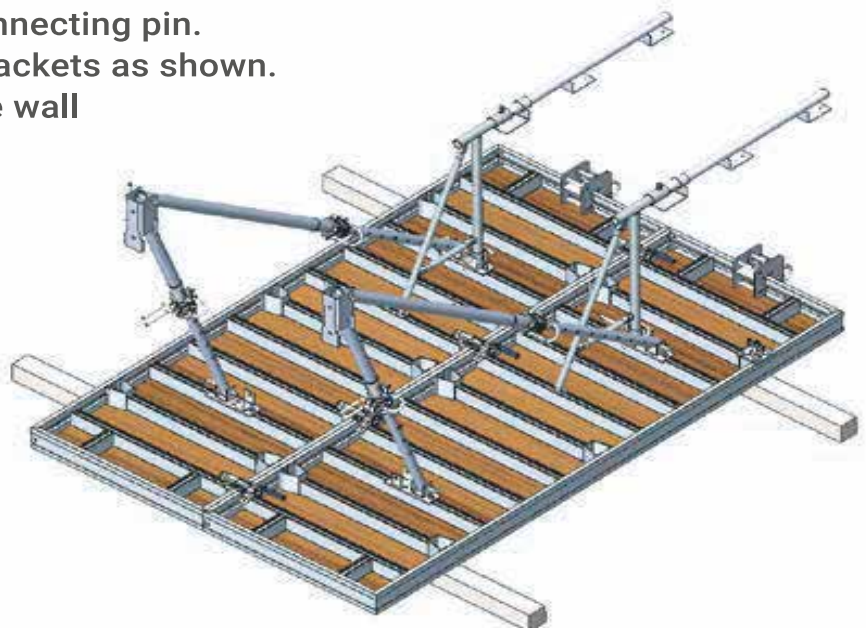

ADX AluPanel System

Product Identification

After Checking of lifting clamp is safe to handle carefully lift the wall panel system and position it vertically as shown.

- 1) Lift the system.
- 2) Spray the release liquid.
- 3) Position the assemble wall panel system where it is going to get fixed.
- 4) Fix the props to the floor.
- 5) Insert the tie rod with plate & wing nut.
- 6) Keep the PVC spacer between the two wall panels, it ensures the distance & parallelism between them.
- 7) Add planks between the walkway brackets. Use wooden decks in guardrails.
- 8) Unhook the lifting clamp.

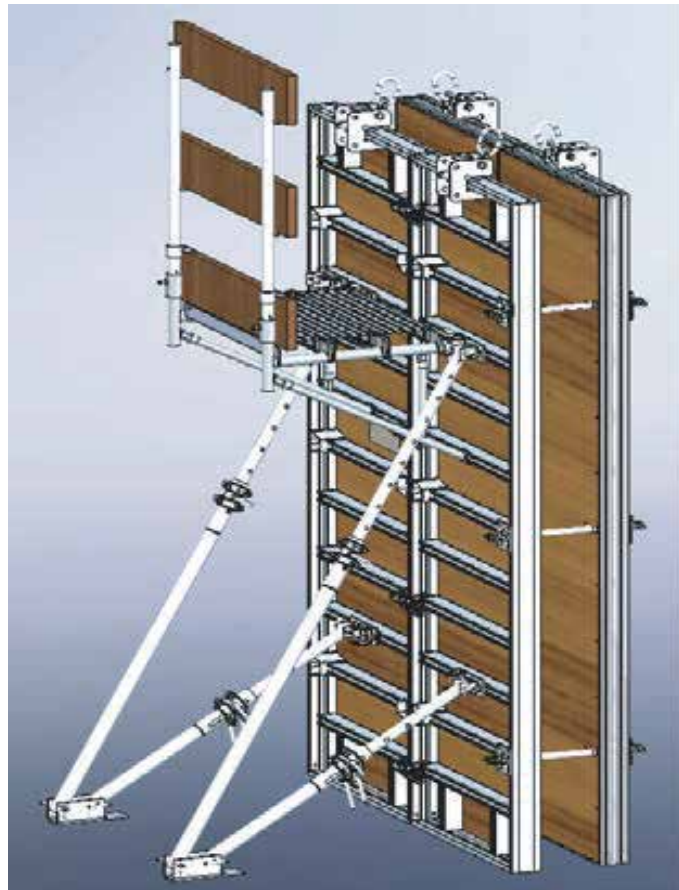
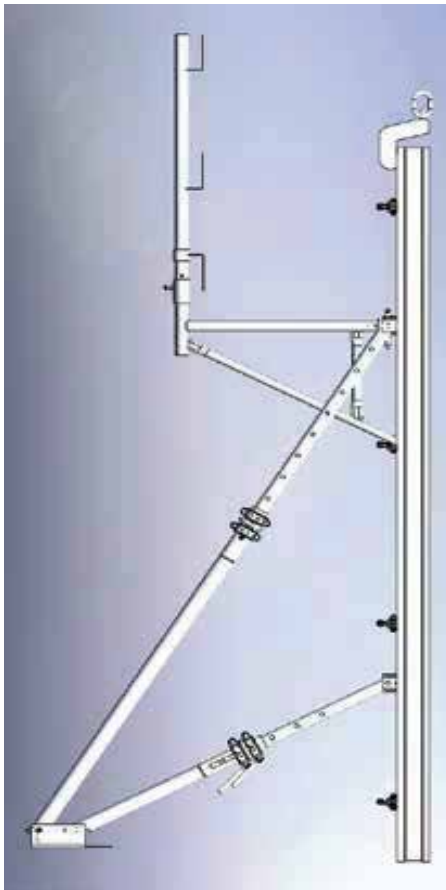

Repeat Same Procedure to assemble corresponding wall panels.

After assembly from both sides, pour concrete – Permissible pressure of fresh concrete 60 kN/m².

ADX AluPanel System

Product Identification

DETAILING OF TIE ROD WITH PLATE

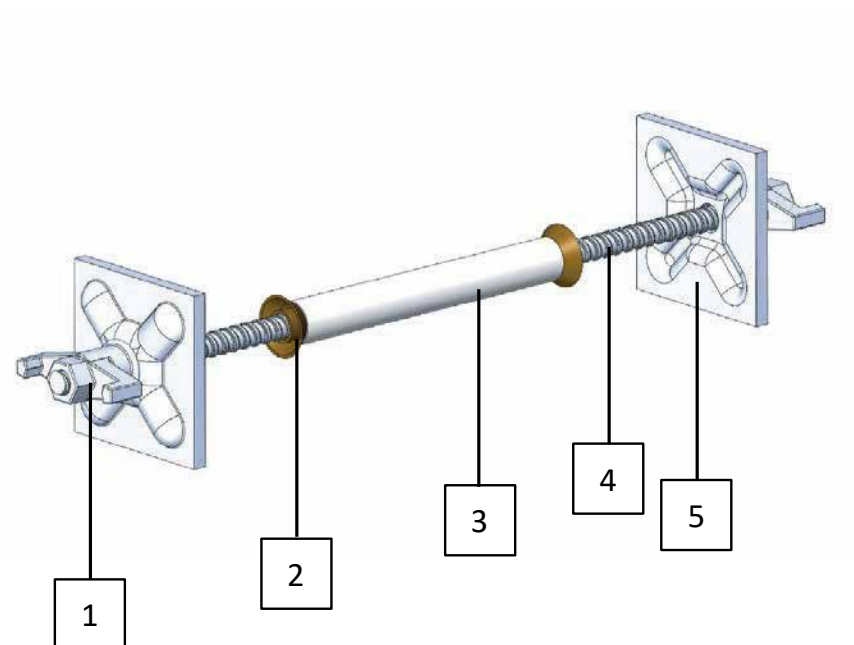

- 1 WING NUT
- 2 PLASTIC PLUGGING CAP
- 3 PLASTIC TUBE
- 4 Ø16.0 TIE ROD
- 5 SUPPORT PLATE

ADX AluPanel System

Product Identification

OPERATING INSTRUCTIONS FOR LIFTING BRACKET

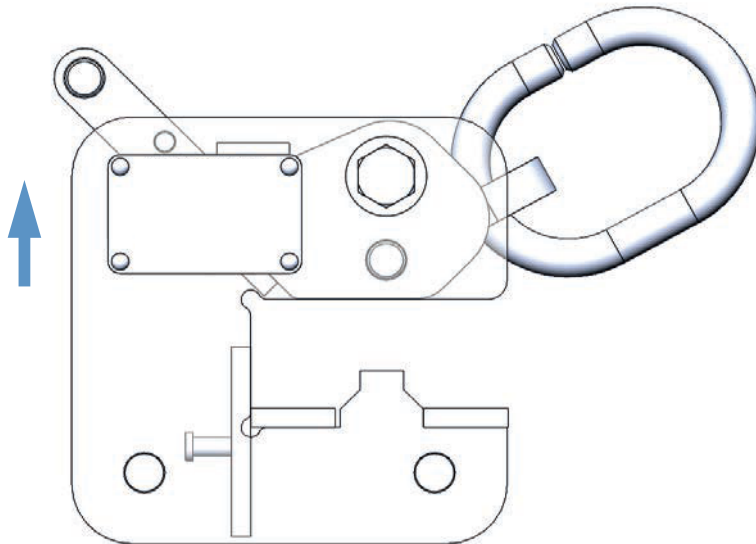

LIFT THE HANDLE UNTIL IT COMES TO A STOP.

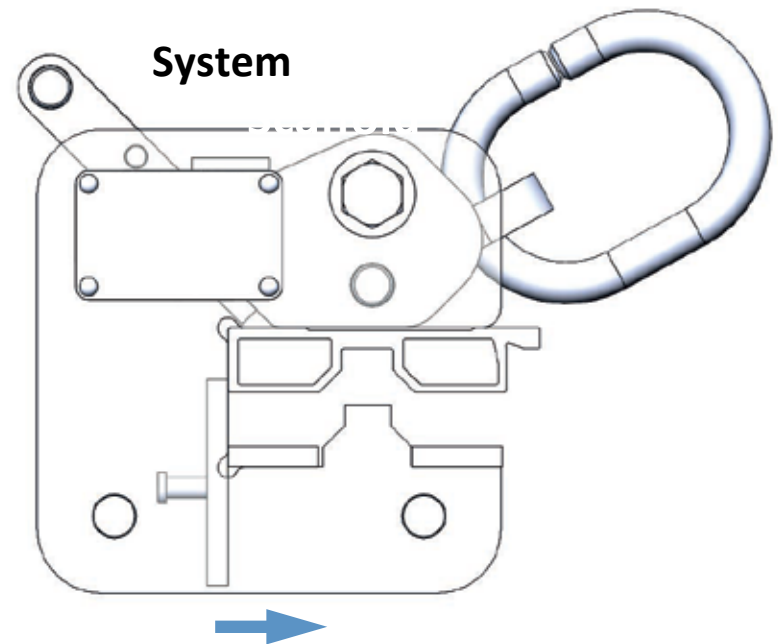

INSERT LIFTING BRACKET ON SECTION OF THE PANEL.

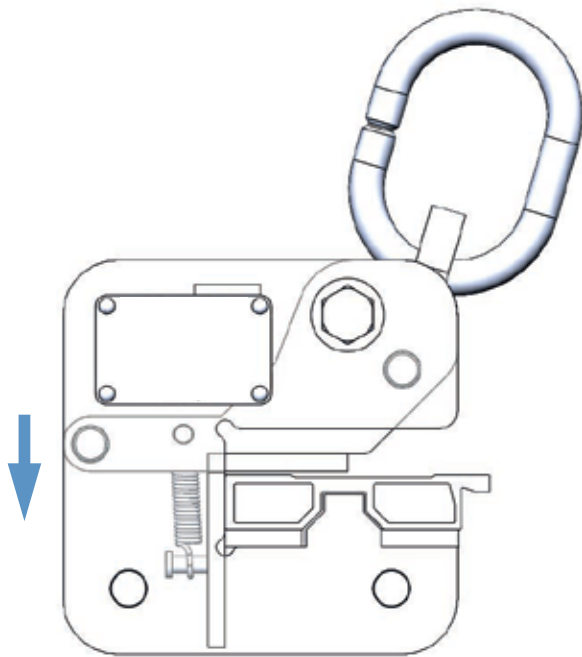

CLOSE THE HANDLE UNTIL IT COMES TO A STOP.



The spreading angle between the ropes of the lifting bracket should not exceed more than 60° as shown.



Maximum load on lifting bracket should not exceed more than 1500 kg. (15KN)

ADX AluPanel System

Product Identification

HIGH WALLS

When there is requirement of more than three meters walls, the waler & clamps are used to connect two panels vertically, this ensures alignment of panels and transmit the anchoring force the panels.

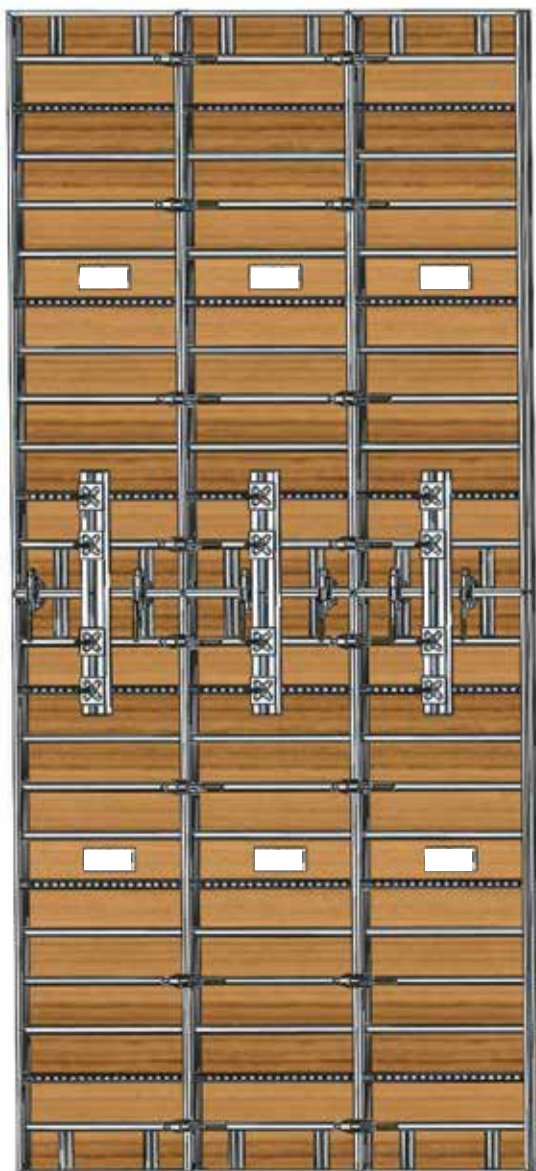

PANEL TO PANEL
CLAMP

UNIVERSAL WALER
TIE CLAMP

UNIVERSAL
WALER

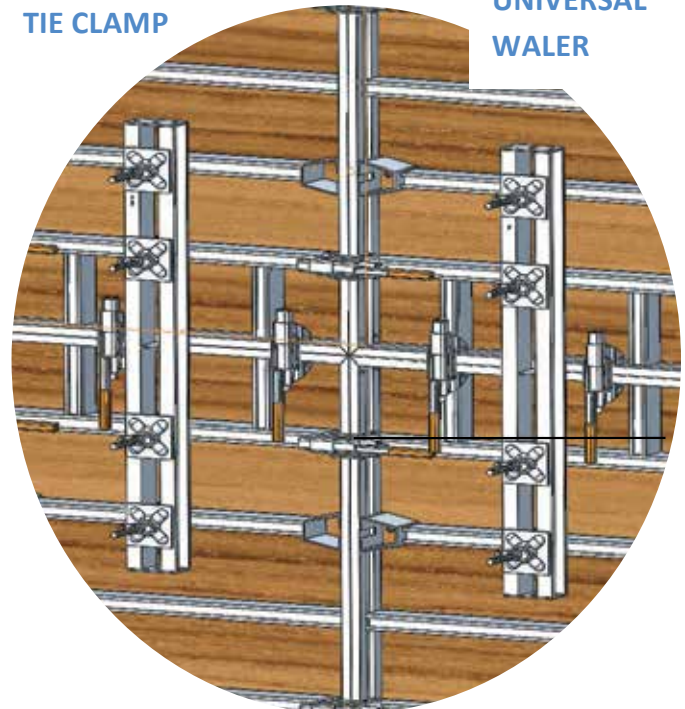

Use panel to panel clamp & universal waler for more than three meter high walls.

ADX AluPanel System

Product Identification

ADJUSTABLE COLUMNS SYSTEM

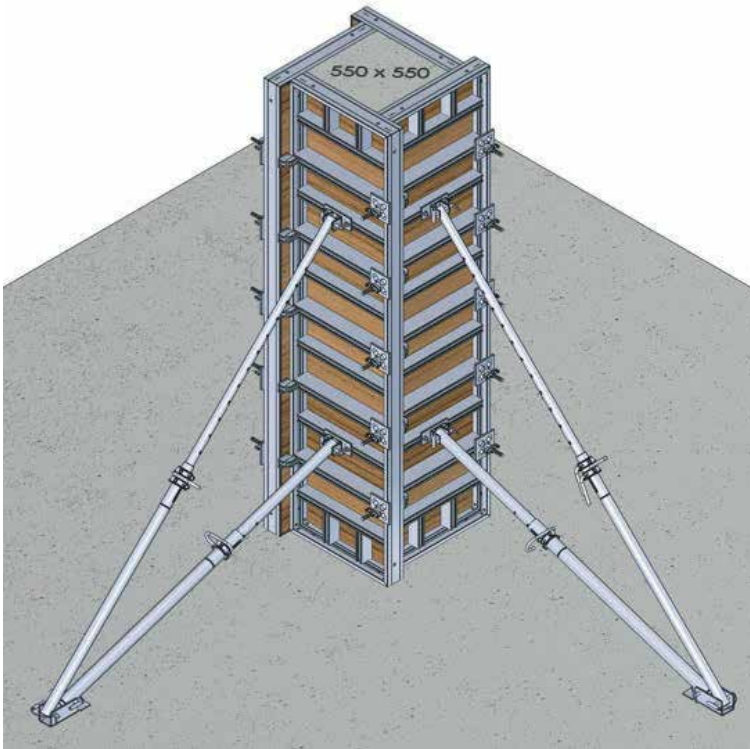

750mm WIDE MULTIPANEL

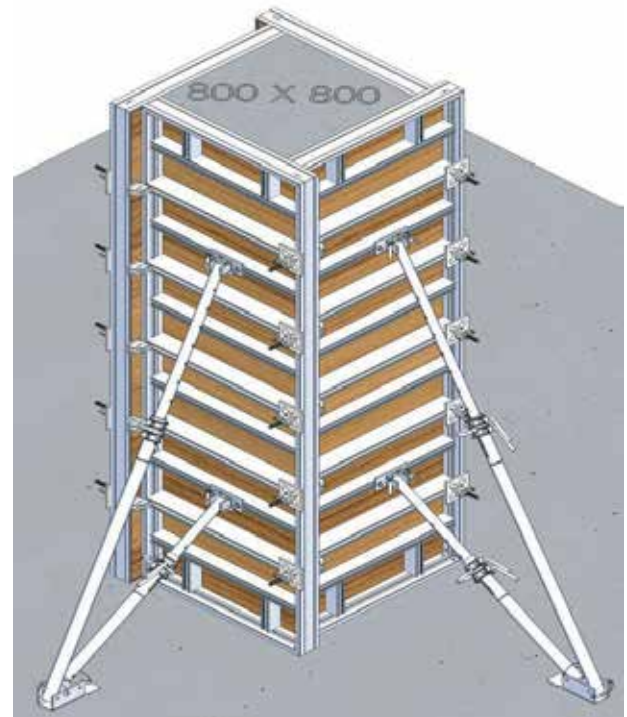

1000mm WIDE MULTIPANEL

COLUMN SYSTEM CHARACTERISTICS	
Material	Aluminium Alloy 6061-T6
Sizes Range for 750 Panel	200x200 to 550x550
Sizes Range for 1000 Panel	200x200 to 800x800
Finish	Mill
Permissible Allowance Fresh	60 kN/msq.

ADX AluPanel System

Product Identification

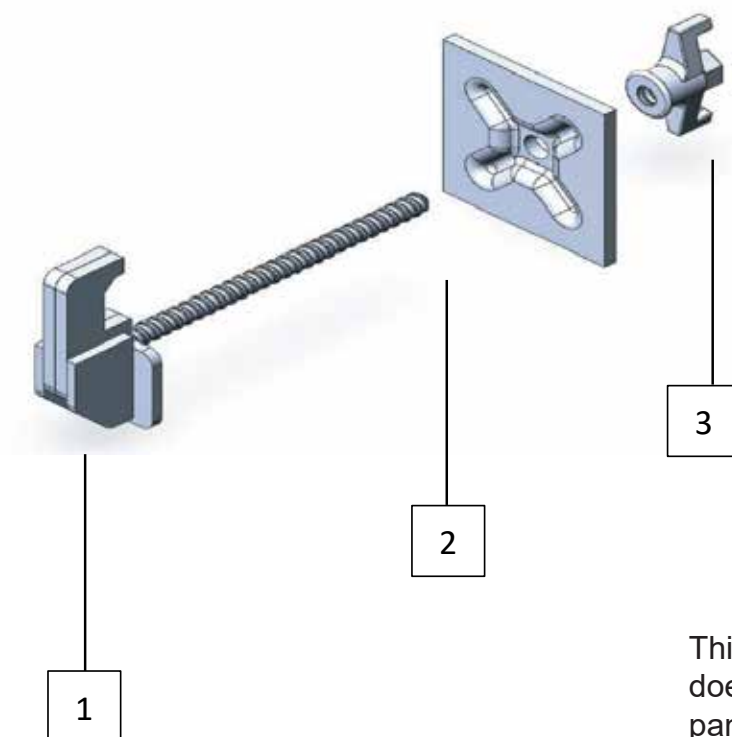
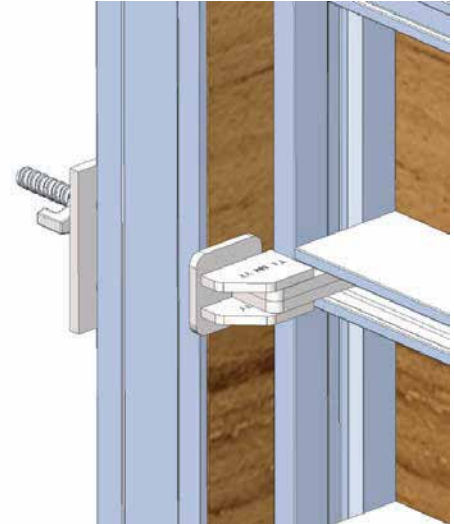
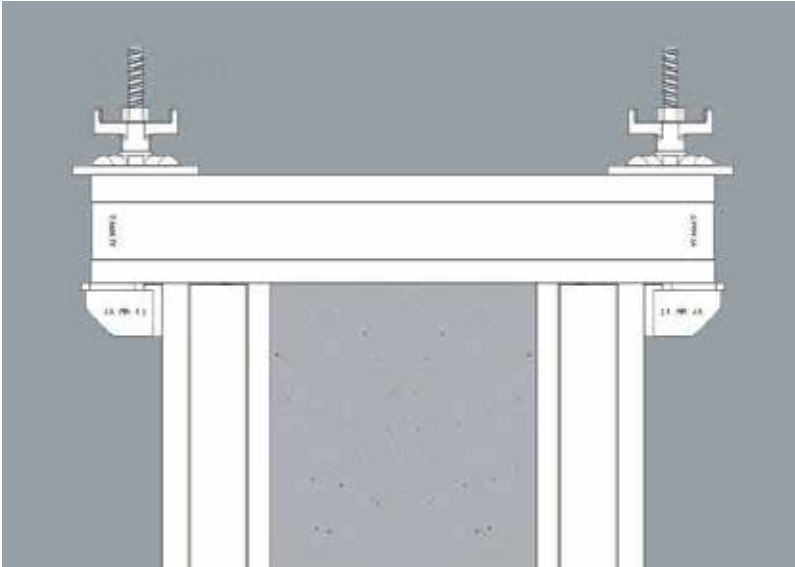

This clamp is used when connections hole doesn't match with each other or where panel to panel clamps cannot be used.

1 MULTI PANEL TIE ROD

2 SUPPORT PLATE

3 WING NUT

ADX AluPanel System Product Identification

COLUMN WITH OUTER CORNER

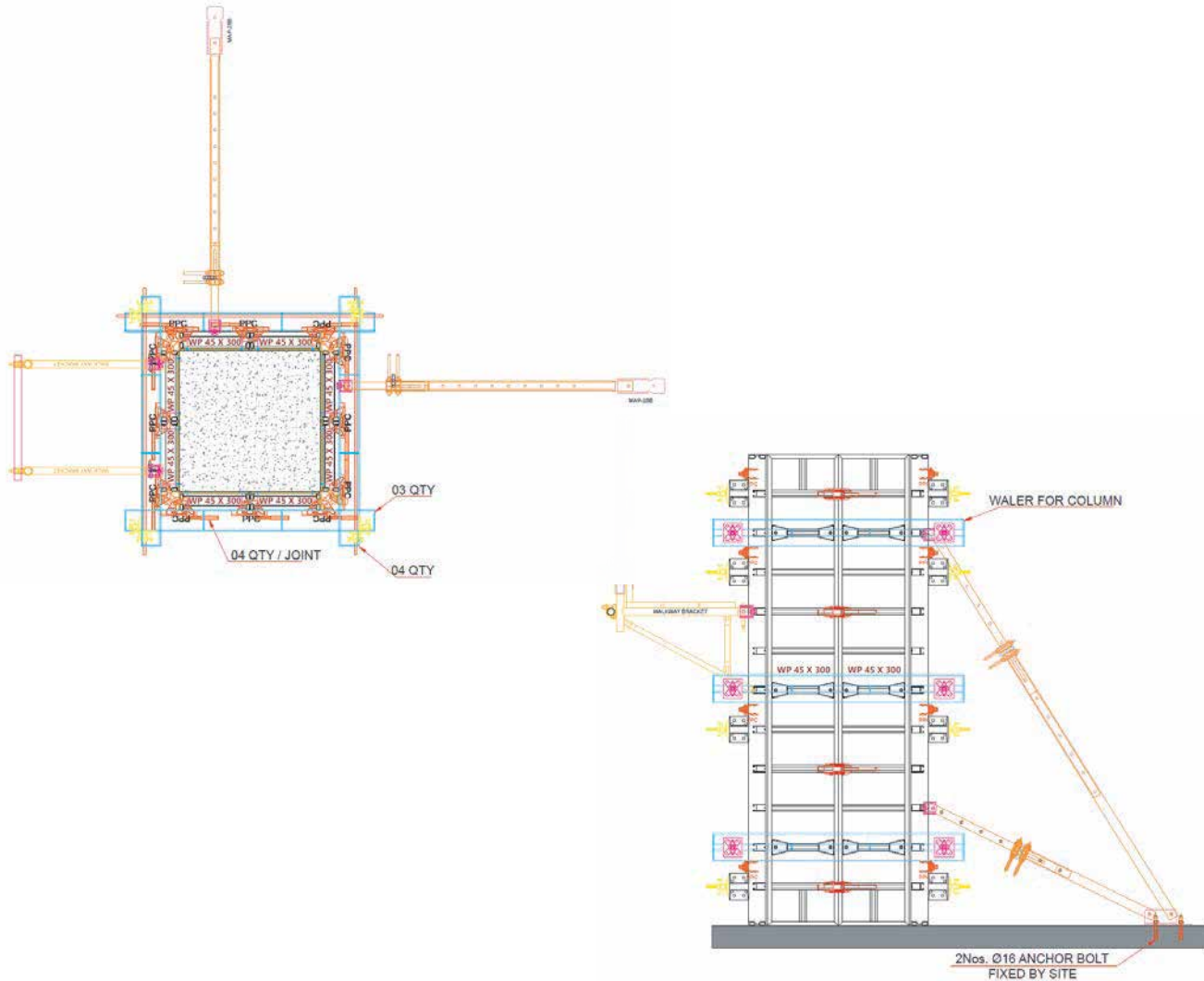

COLUMN WITH OUTER CORNER CHARACTERISTICS

Material	Aluminium Alloy 6061-T6	
Sizes for 1.5M Height	750x750mm	1000x1000mm
Sizes for 3.0M Height	750x750mm	1000x1000mm
Finish	Mill	
Permissible Fresh Concrete Pressure	60 kN/msq.	

ADX AluPanel System

Product Identification

COMPENSATION BETWEENWALL PANELS

Compensation wood is kept between the two Multi panels to complete the formwork which is having small gaps. Two panels are then clamped between the compensation using adjustable panel clamp. Using Adjustable panel clamp sizes up to 300 mm of compensation timber can be used. Also use Universal Waler at tie rod hole position to avoid the panel deformation as shown in the below sketch.

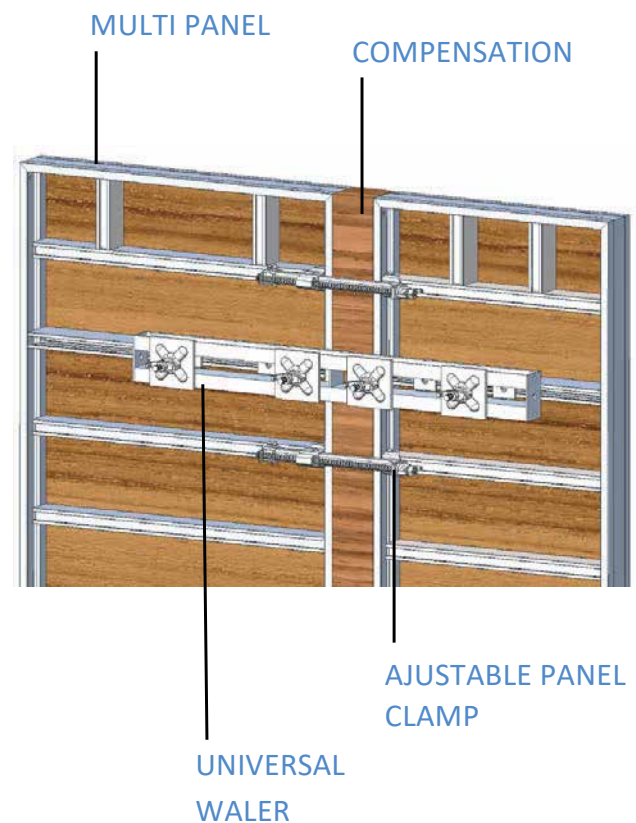
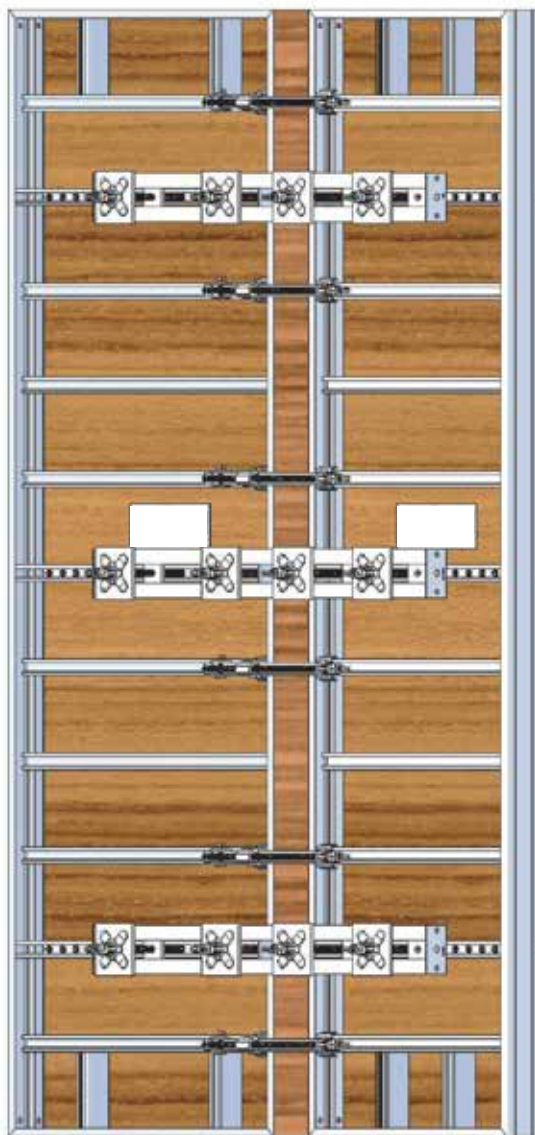

ADX AluPanel System

Product Identification

WALL PANELS AT CORNERS

Using Multi-panels at the corners of the walls, there is no need of the compensation element (Timber) for wall width up to 500.0mm.

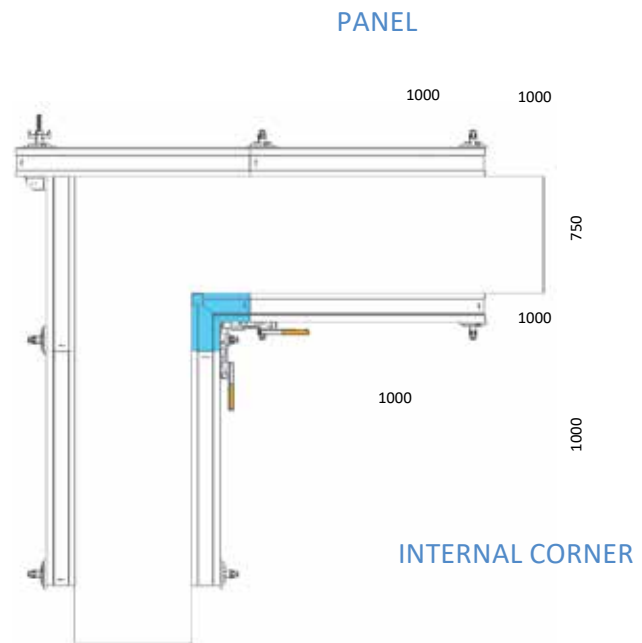
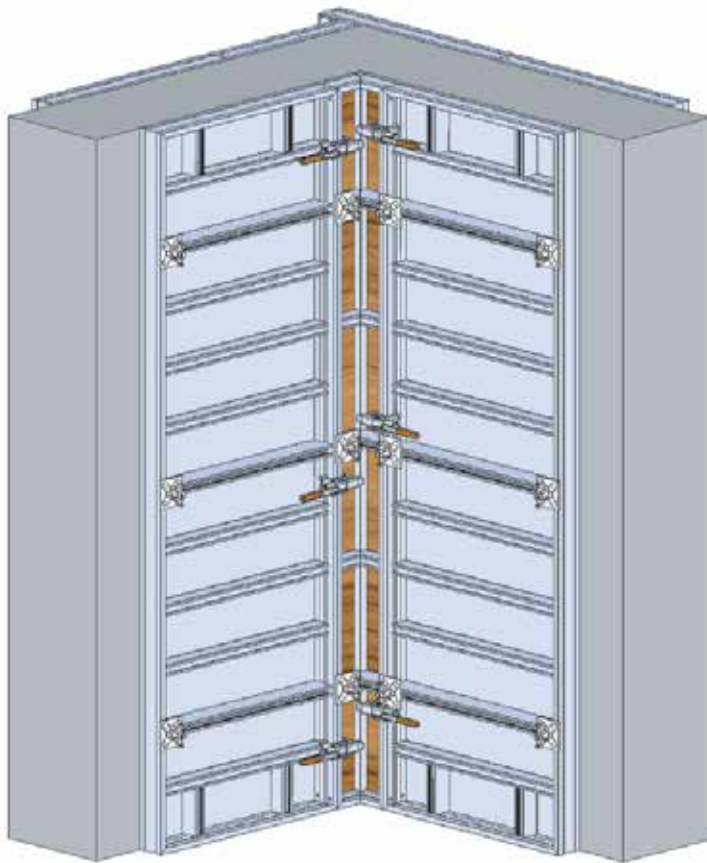

WALL PANELS AT T-CLOSURES

Wall panels at T-Closures can be easily assembled using multi-panels, this setup may or may not require compensation element (Timber).

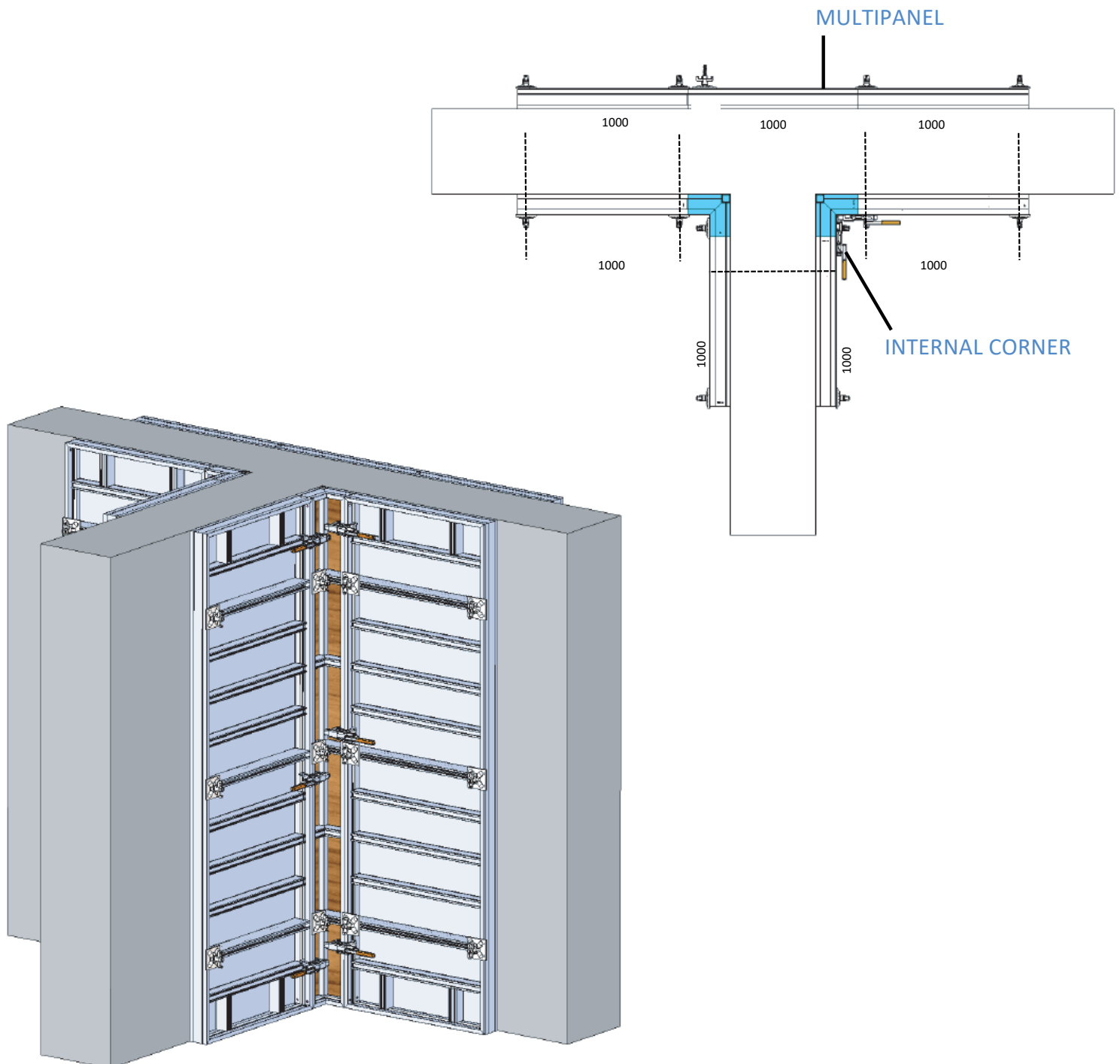

ADX AluPanel System

Product Identification

WALL PANELS AT CONTINUING WALL

Existing walls can be continued using wall panels, the side off wall panels can directly touch to the face of the existing wall, as shown in image.

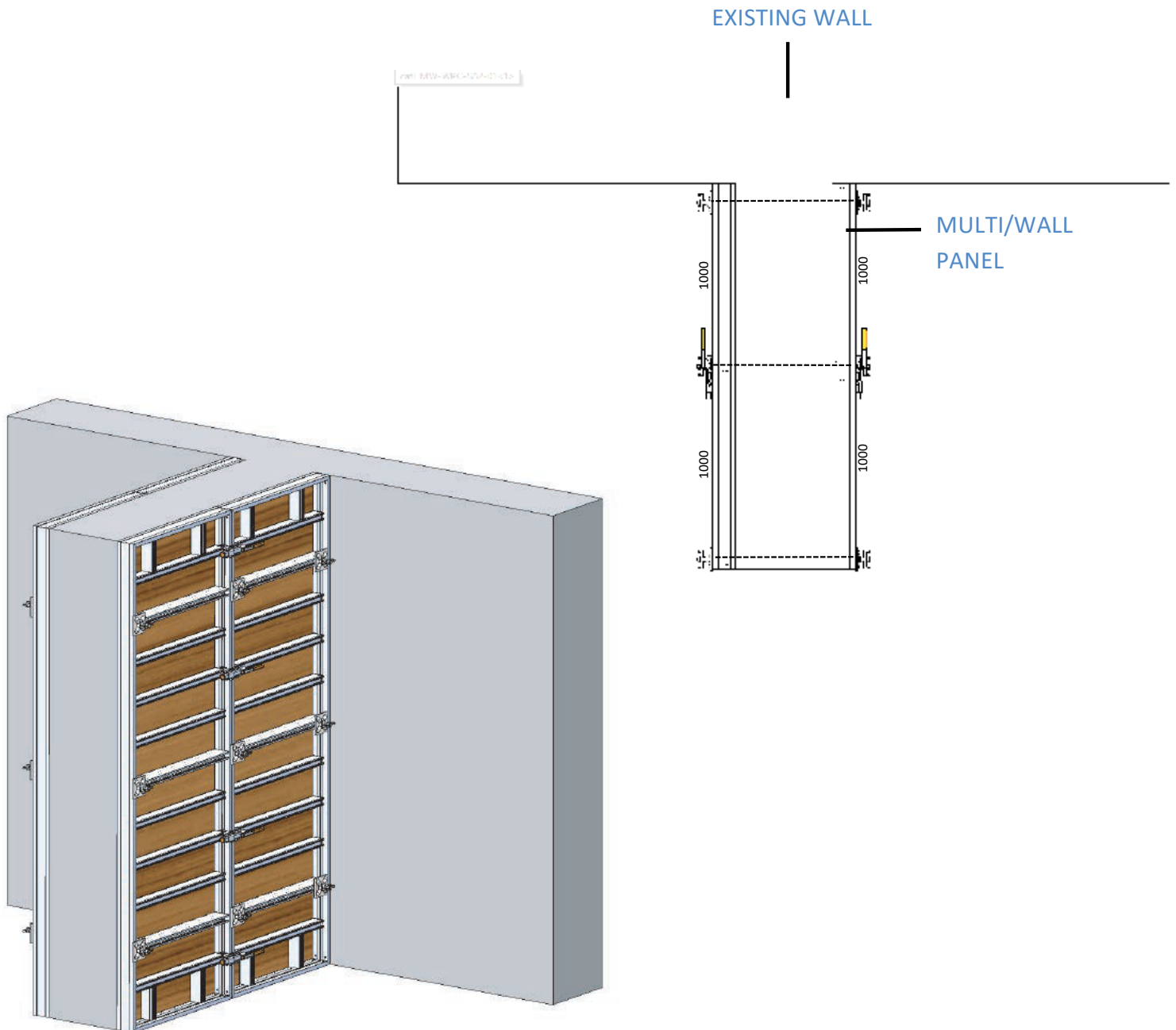

ADX AluPanel System

Product Identification

OUTSIDE CORNER 90

Outside corner is a solution for the walls with sharp 90° turn, it is clamp to the wall panels or multipanel as per requirement of the site.

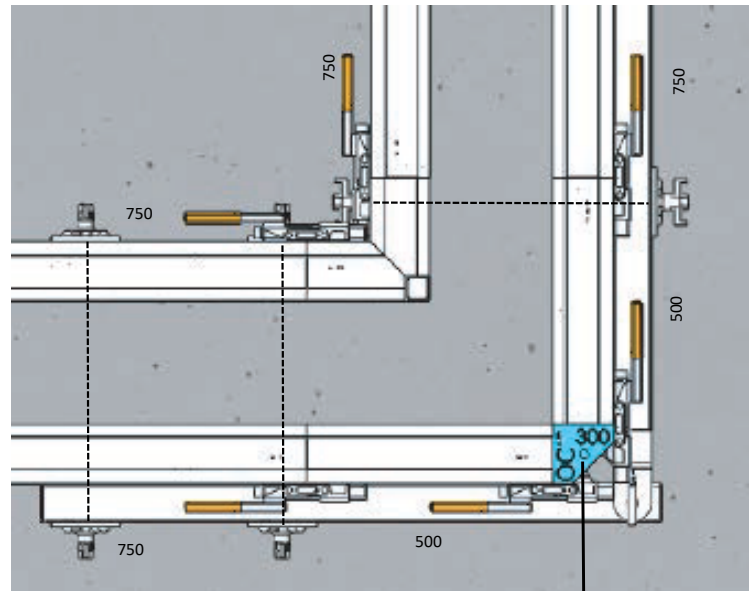
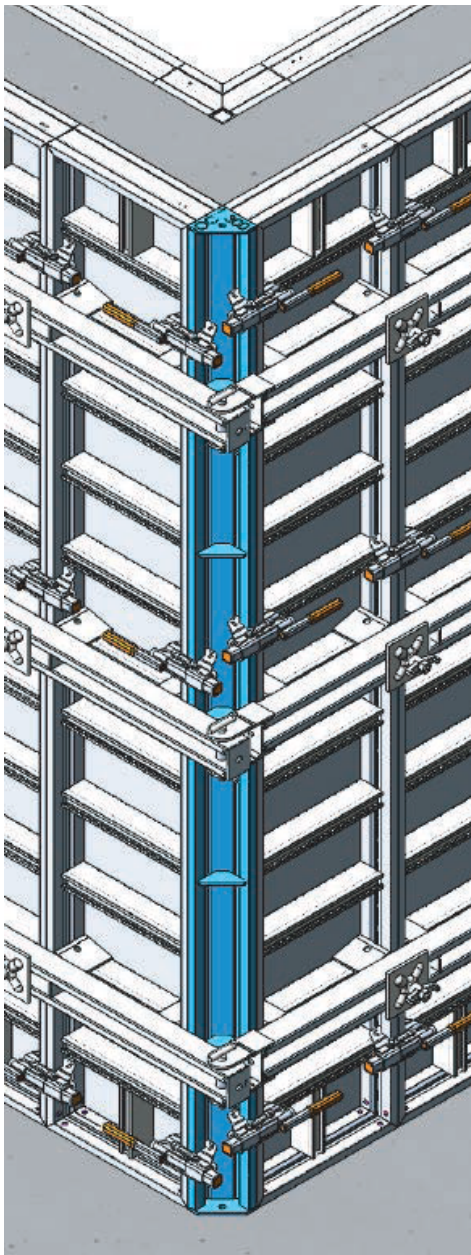

OUTSIDE CORNER

ADX AluPanel System

Product Identification

SWING CORNER WITH HINGE WALER

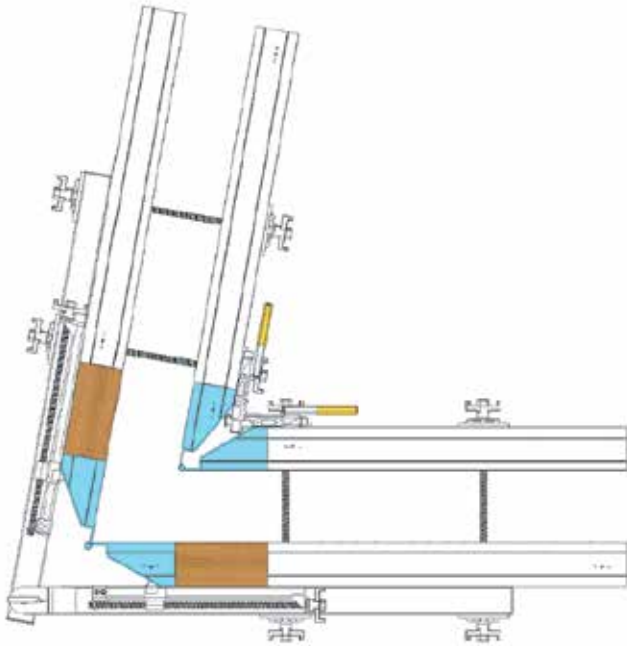
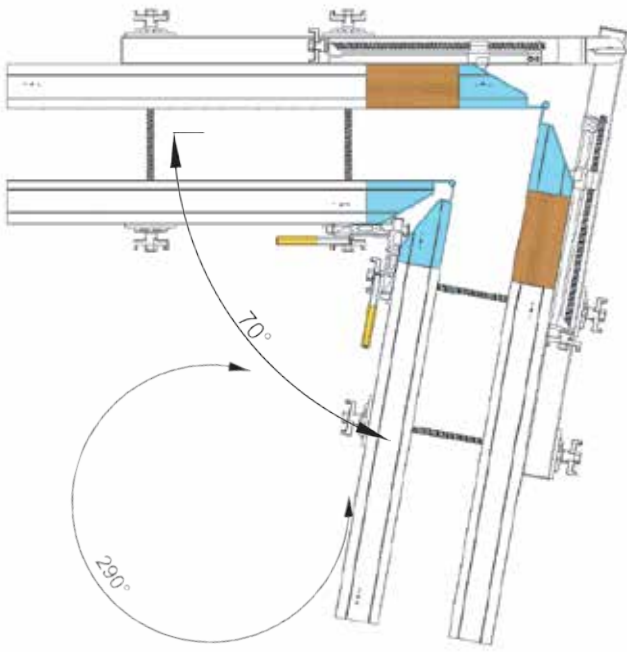
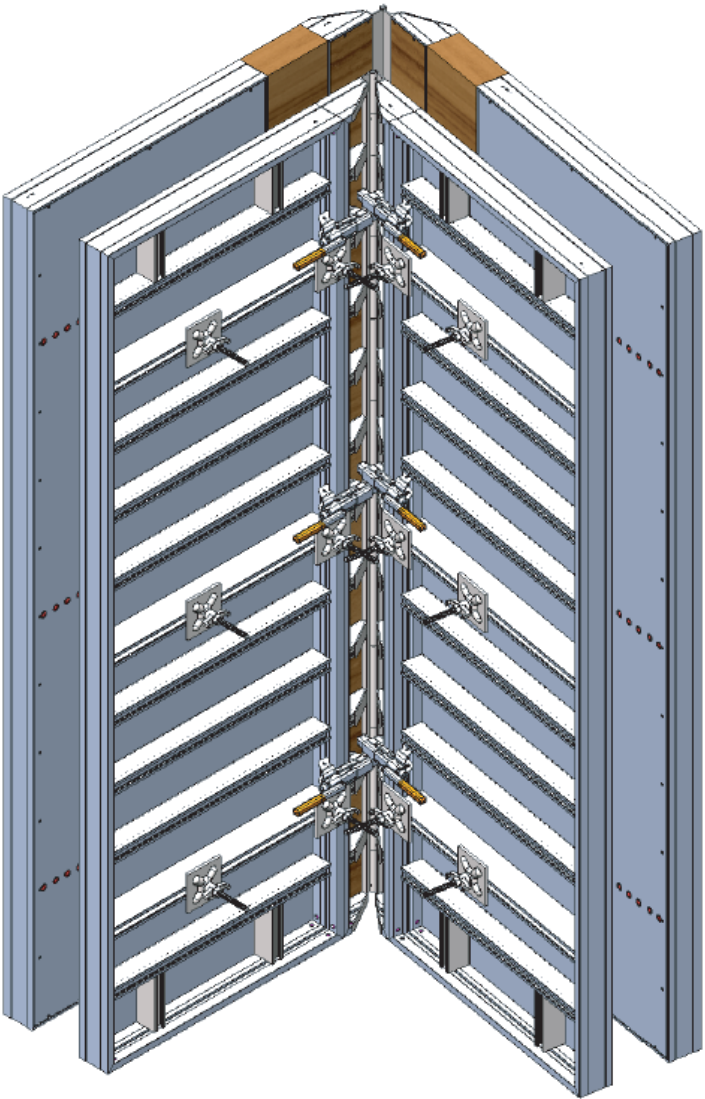

ADX AluPanel System

Product Identification

SINGLE SIDED WALL SOLUTIONS

Single sided wall solutions are meant to be provided where the wall panels from both sides are not possible, single sided wall solutions is used for retaining walls. Structural members are arranged and fixed to panels to withstand the permissible loads acting on the panels.

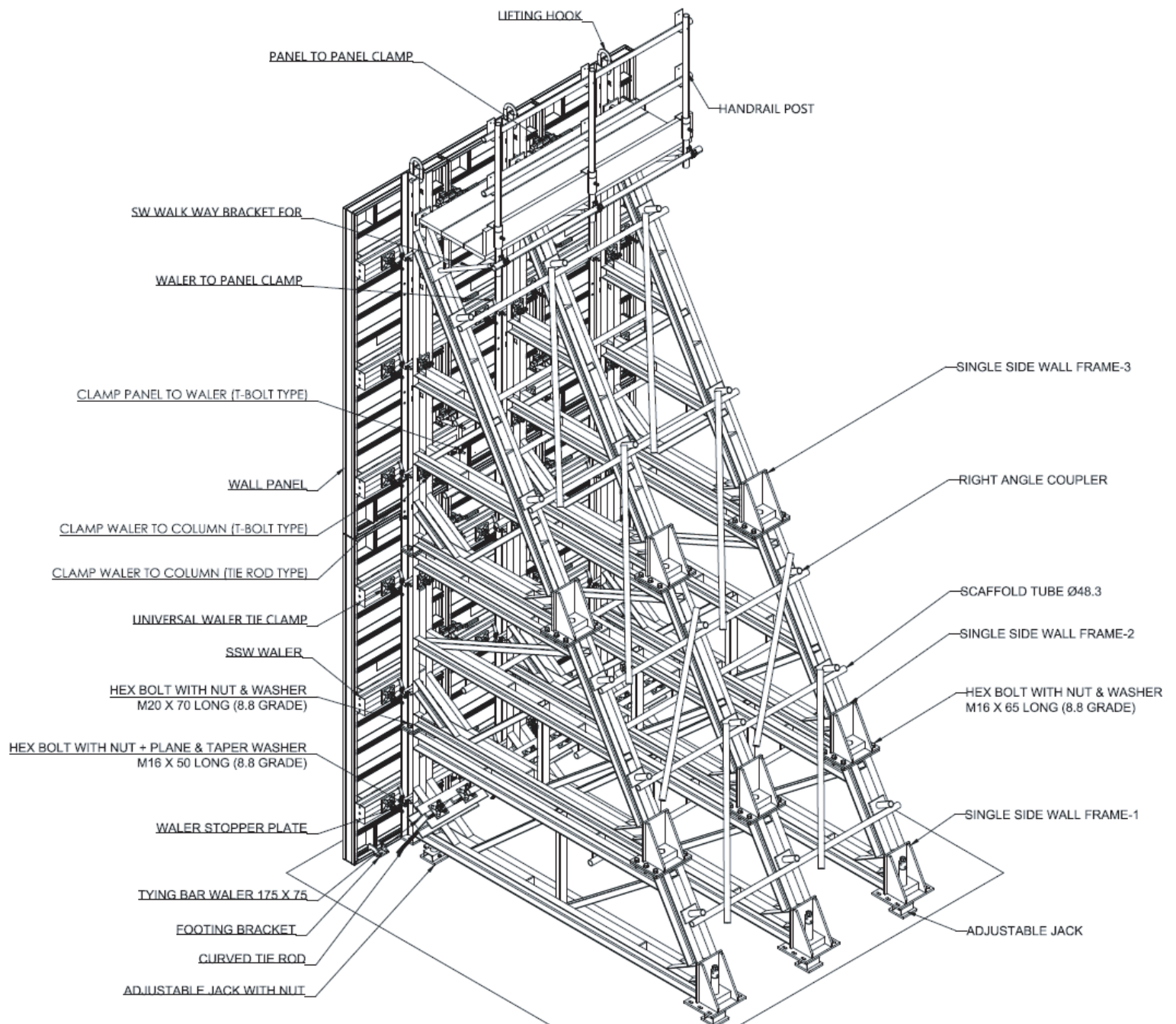

TYPICAL ARRANGEMENT OF SINGLE SIDED WALL